

TONIC II

Basin 102 cm

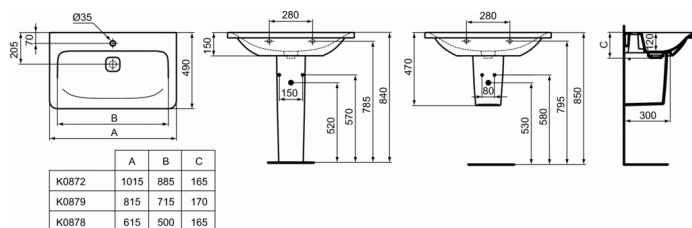

Basin 102 cm

1 tap hole punched

Including:

- Standard IdealFlow N8326AA (1 pc included)
- Ceramic waste cover (1 pc included) T854601

In carton box

EN 14688

For assembly with: Tonic II Pedestal, Semipedestal, Furniture Basin structures or Design siphon

Recommended equipment:

- Floor standing pedestal (T429201)
- Semi-pedestal (T429301)
- Fixation set M10 x 140 mm (WW965340)
- Design siphon G1 1/4 (in case of installation without semi-pedestal and without base cabinet) (E0079AA)
- Design stop angle valve (water connection G1/2, connection with mixer 10 mm/ G3/8) (A3491AA)

RECOMMENDED

One-hole basin mixer
Semi-pedestal

A6326
T4293

FINISHES*



01

* 01 = Euro White

KEY FEATURES & BENEFITS

