

Prestigio



Car Video Recorder

RoadRunner DIAMOND

User Manual

About this user manual

This user manual is specially designed to detail the device's functions and features.

- Please read this manual before using the device to ensure safe and proper use.
- Descriptions are based on the device's default settings.
- Prestigio continuously strives to improve its products. Due to software upgrading, some contents in this user manual may be different from your product. Prestigio reserves the rights to revise this user manual or withdraw it at any time without prior notice. Please take your product as standard.

Conventions used in this manual

In this user manual, we use the following symbols to indicate useful and important information:



Caution: provides safety precaution and important information.



Note: gives additional information.



Tips: usage tips.

- > The order of options or menus you must select to perform a step.

1. Unboxing



Inside your package

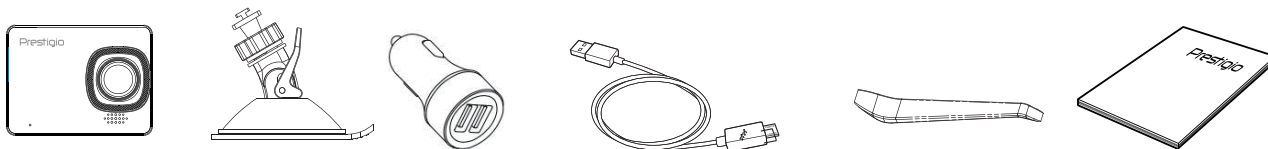

Car Video Recorder
Car Charger
USB Cable
Magnetic Cradle

Crowbar
Quick Start Guide
Warranty Card

Device overview

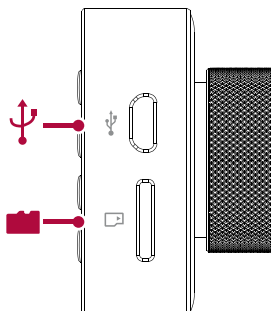
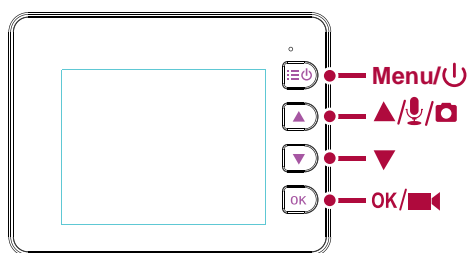
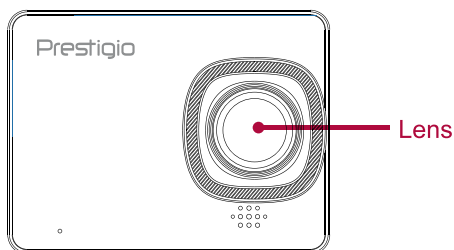

2. Getting started

2

Insert a microSD card

Before starting video recording, please insert a microSD card (not included) into the slot until it locks in place.

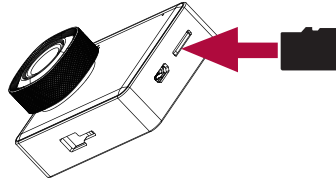

The device will automatically recognize it as default storage and all the data will be saved on this card.

Install the Magnetic Cradle

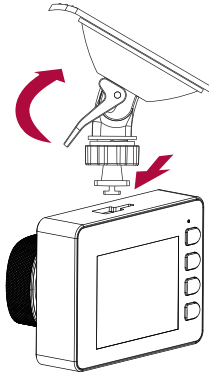

Charge the battery

Before using the device for the first time, please fully charge the Li-ion battery. The battery will be completely charged in 2-3 hours.

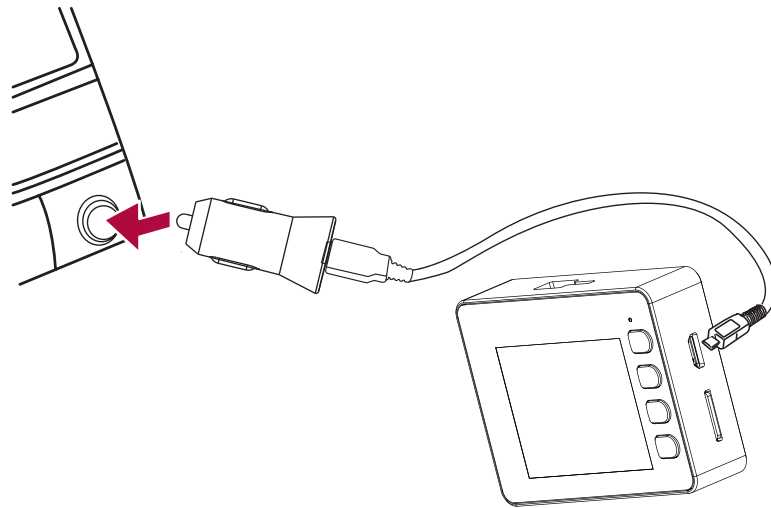

- Using the car charger: charge the device through cigarette lighter. The device will start charging after the car engine is turned on.
Please connect the car charger to the micro USB port on the cradle.
- Using USB cable: connect the device to AC 5V adapter or the USB port of a computer/laptop.

3. Settings



Before recording, you can set up the device according to your requirements.

- In video/picture preview mode, press [MENU] to enter video/picture settings, press it again to go to general settings, press it third time to exit.
- In setting list, use [▲]/[▼] to navigate the menu, press [OK] to confirm the selection, and [MENU] to exit.

Video settings

- Resolution: Select the video image size from 1296@20FPS 1080@30FPS 720@60FPS
- Loop recording: Select the loop recording from off/1 min. / 3 min./ 5 min.
- Date Stamp: Select the date stamp from off/Date&Time/Date
- EV Bias: Select the exposure from +2.0,+5/3,+4/3,+1,+2/3, +1/3, 0, -1/3,-2/3,-1,-4/3,-5/3,-2.0
- G-sensor: Select the sensitivity of the G-sensor. When reaching the sensitivity value(such as collision), the recording file will be automatically protected.
- Motion Detection: In the standby mode, press Menu button to set the function on, the device will start video recording automatically if it detects a moving object in front of camera and stop recording when there is no movement detected.

General settings

- Language: Select the desired language from the list.
- LCD Off: Select to turn LCD on or off.
- Beep sound: Select to turn beep sound on or off,
- Date&Time: Select the date and time display format, MM/DD/YY
- Format SD Card: Select to format the SD Card.
- Default Setting: Select if return menu setting to defaults or not.
- Version:Display the current FW version.

Playback settings

Press down button to enter playback mode. The last recorded file will be displayed. Press the up/down button to view the files.

Press the OK button to play the files. Meantime, under play mode, press up/down to FORWARD/BACKWARD the file, then press OK button to pause. Press the Menu button back to the playback menu. To enter menu options press OK button, the following settings are available:

- Delete Files: Select the file / files you want to delete.
- Protect Files: Select the file you want to lock or unlock.

4. Recording

Record a video

Auto video recording

Connect the device to car charger, when the car engine launches, the device will automatically turn on and start loop video recording. When shut off the car engine, the device will save the last file and turn off.

Manual video recording

In preview mode, press [OK] button to start and stop video recording.

Record the sound

In preview mode or recording mode, press [▲] to turn on or off microphone.

Take a picture

- Press [📷] to take photos.

5. File management

You can manage your videos and pictures in playback mode.

Browse files

1. In preview mode, press and hold [▲] to enter the playback mode.
2. Press [▲]/[▼] to scroll through the files.

Delete a file

Press [MENU] to delete one file or all the files, and press [OK] to confirm the deletion.



To delete a protected file, remove the protection first.

Lock and unlock a file

Press [MENU] to protect or unprotect the selected file or all.

6. Playback

6

Play video on DVR

1. In playback mode, press [▲]/[▼] to scroll through the files.
2. Press [OK] to start playback.
3. Press [▲]/[▼] to slow down or speed up playing.
4. SHD 1296P can only be played on APP and PC.

Playback on PC

Remove memory card from DVR and insert it into computer's card reader.



DVR's USB port is for charging purpose only.

7

7. Specifications

Display	2.0", 960 x 240 pixels
Processor	Ambarella A12A25
Image sensor	2.0 MP CMOS 1/3"
View angle	150°
Video resolution	Super HD 2304x1296@20FPS Full HD 1920x1080@30FPS HD 1280x720@60FPS
Video codec	MOV(H.264)
Picture format	JPEG
Memory	up to 128GB (microSD Class 10)
Microphone	Built-in
Additional features:	Cyclic recording, Motion Detection, Parking mode, G-sensor, High Dynamic Range, Low Light Warning, Forward Car Movement Detection, OVP, NTC
Wifi	Yes
Power source	Built-in battery 320 mAh, car charger
Interfaces	Micro USB (for charging only)
Operating temperature	0 °C ~ 45°C
Dimension	66 x 50 x 18mm (H x W x D)
Weight	74 g