



Gebrauchs- u. Montageanleitung - Servicekarte  
Assembly instructions - service card

Ident.-Nr



77319

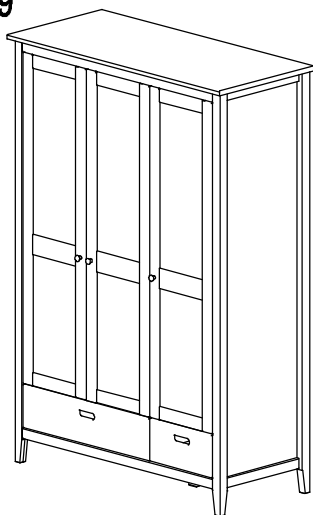

A=46x



B=46x

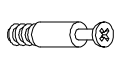

C=24x

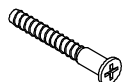

D=20x



E=2x



F=12x



G=30x



H=5x



I=9x



J=4x



K=16x



L=2x



M=1x



N=6x



O=3x



P=9x



Q=4x



R=4x



S=4x



T=4x



U=8x



V=2x



W=2x



X=2x



Y=2x



Z=6x



Name:.....Strasse:.....

Ort:.....Telefon:.....

Wellemöbel

<http://www.welle-moebel.de>

e-mail: [info@welle.com](mailto:info@welle.com)

fax: +49 (0) 52 51-883 645

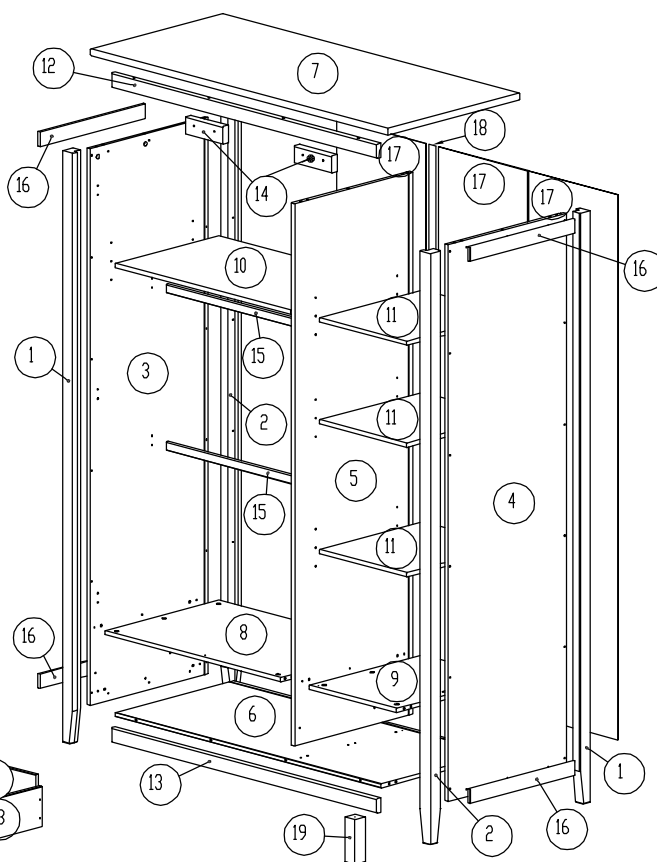
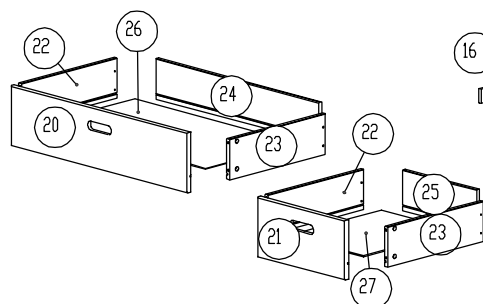
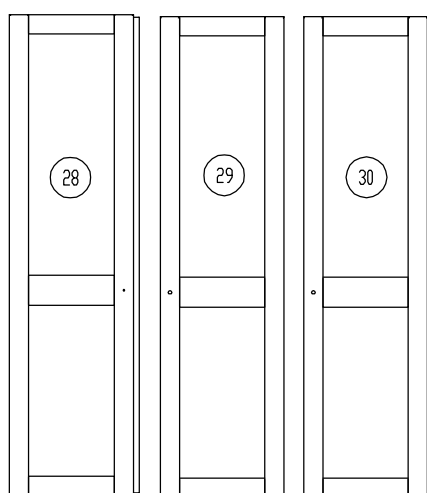

1

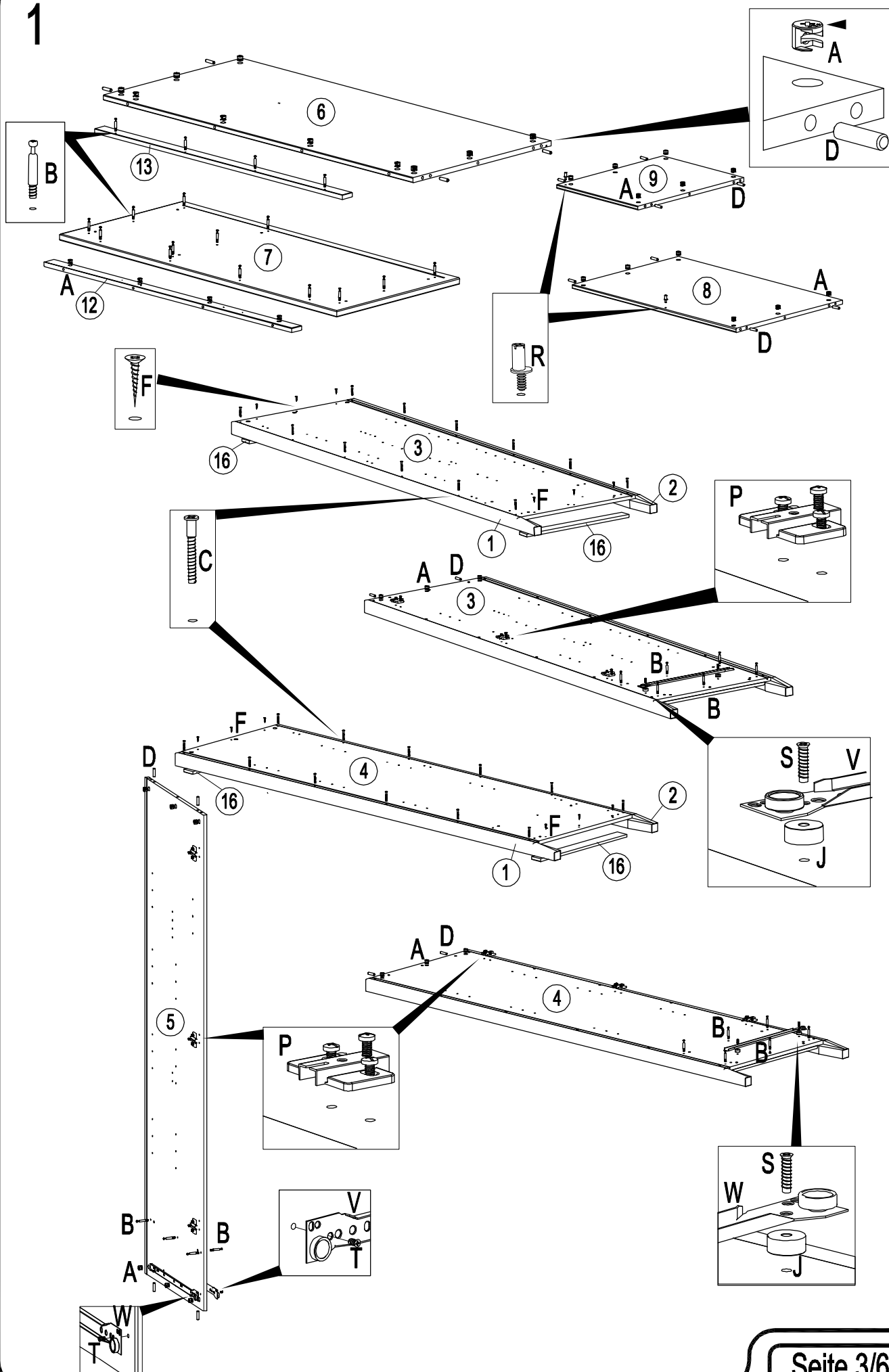

2

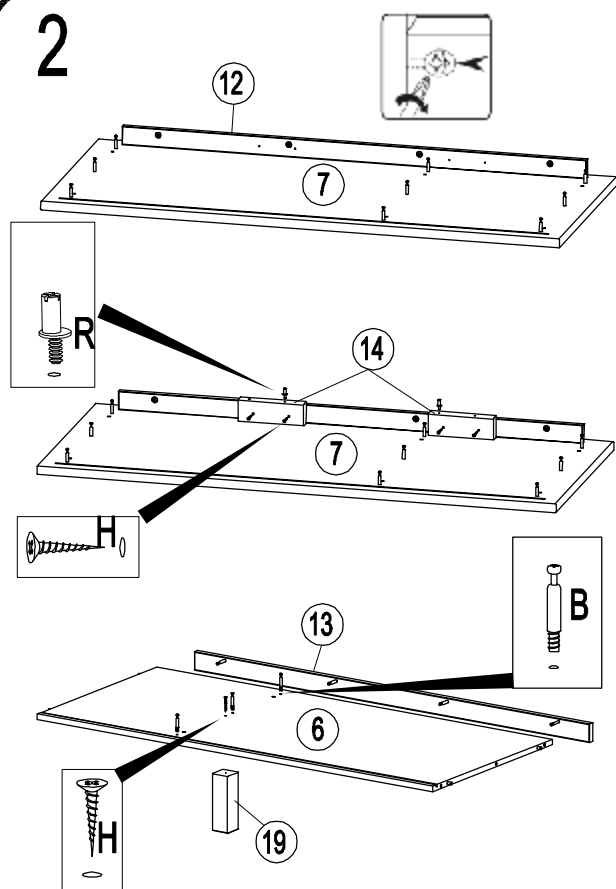

3

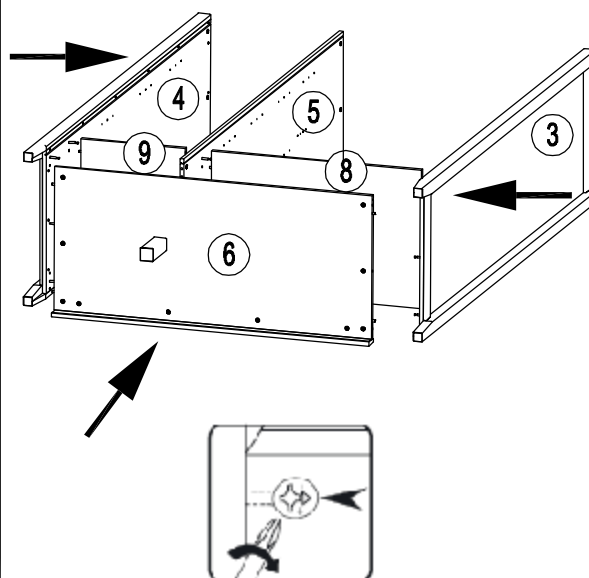

4

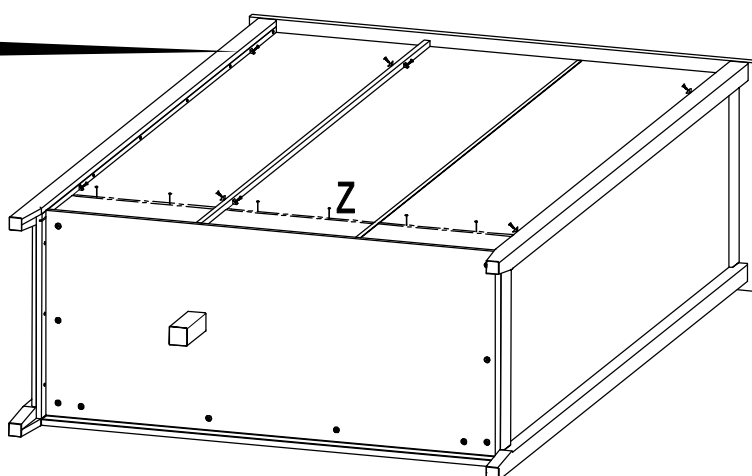
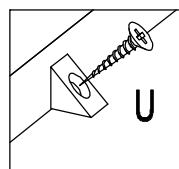
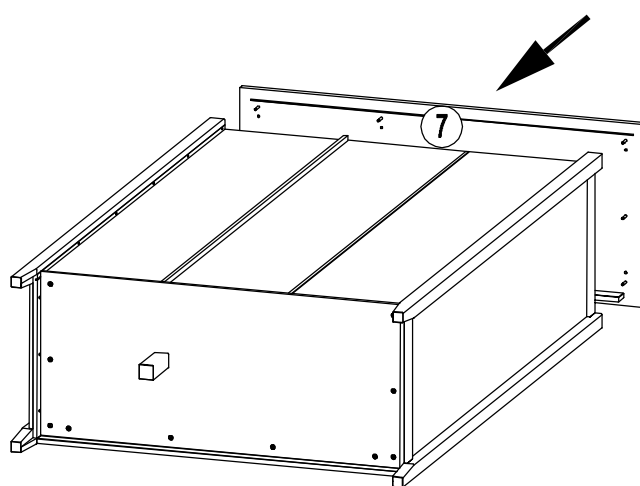
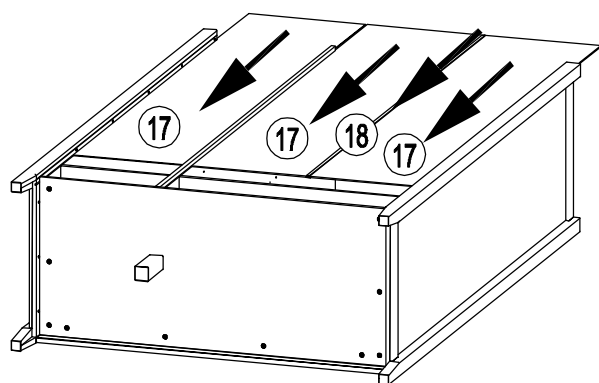

# 5

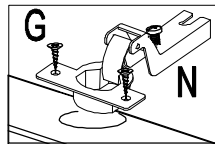

Sollte das Schloss im Laufe der Zeit etwas Schwergängig werden, liegt dies daran, dass das Schlossgehäuse austrocknet. Bitte benutzen Tropfen Öl, um das Schloss wieder gängig zu machen!

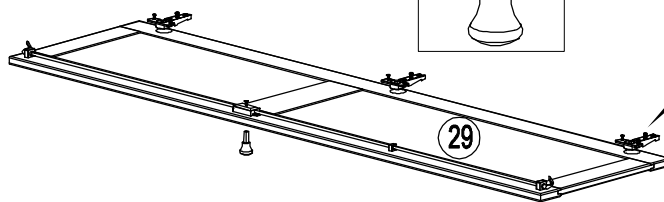
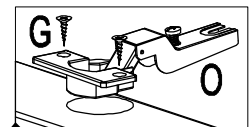
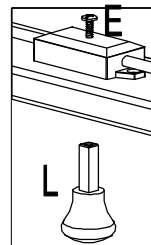
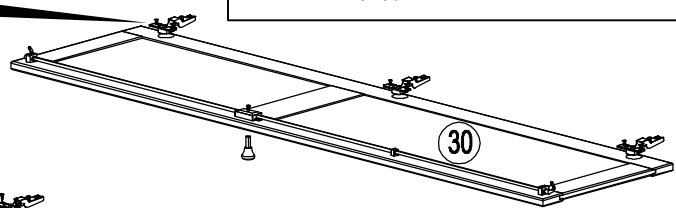
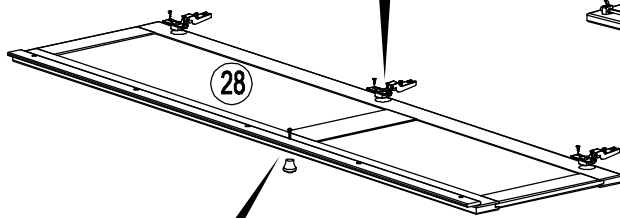

# 6

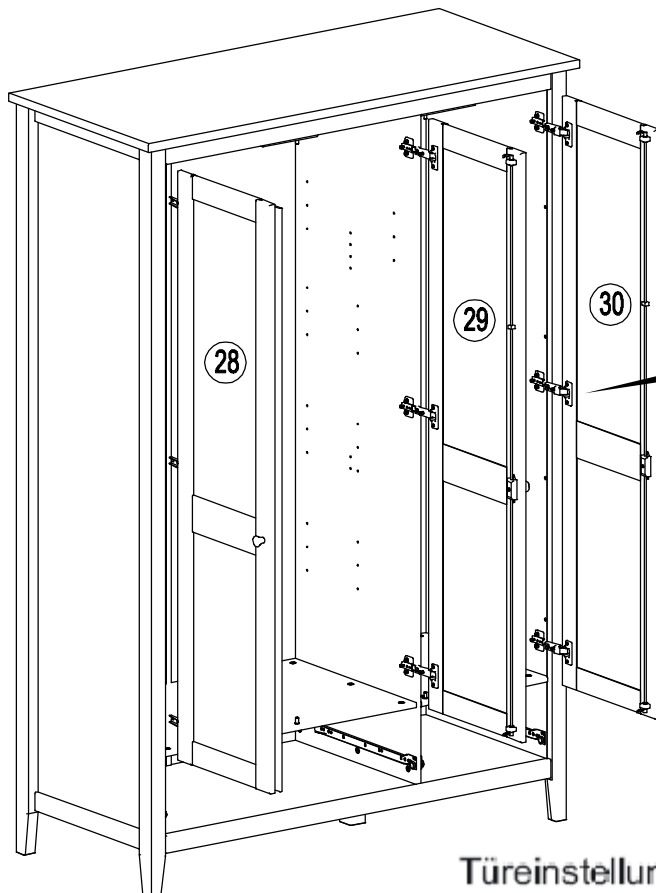

Türeinrichtungen

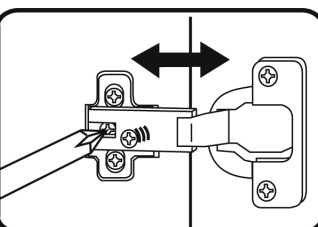
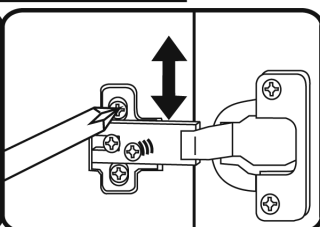
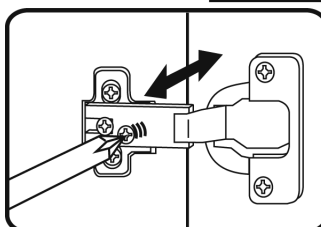
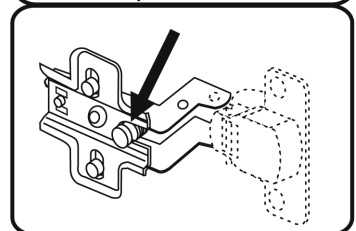
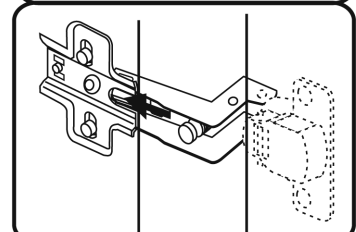
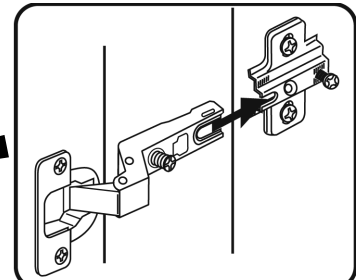
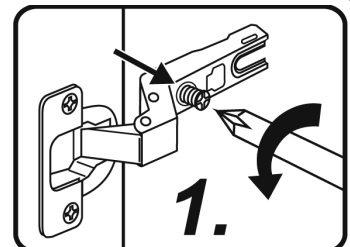

7

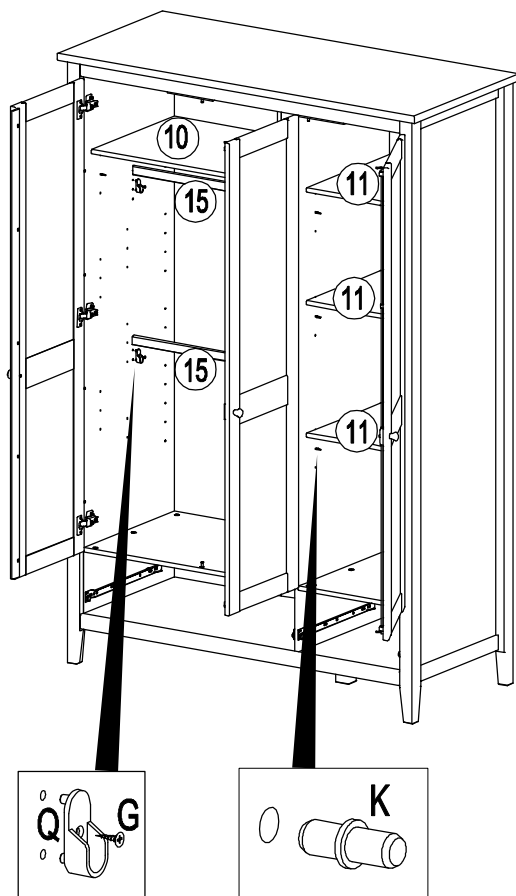

8

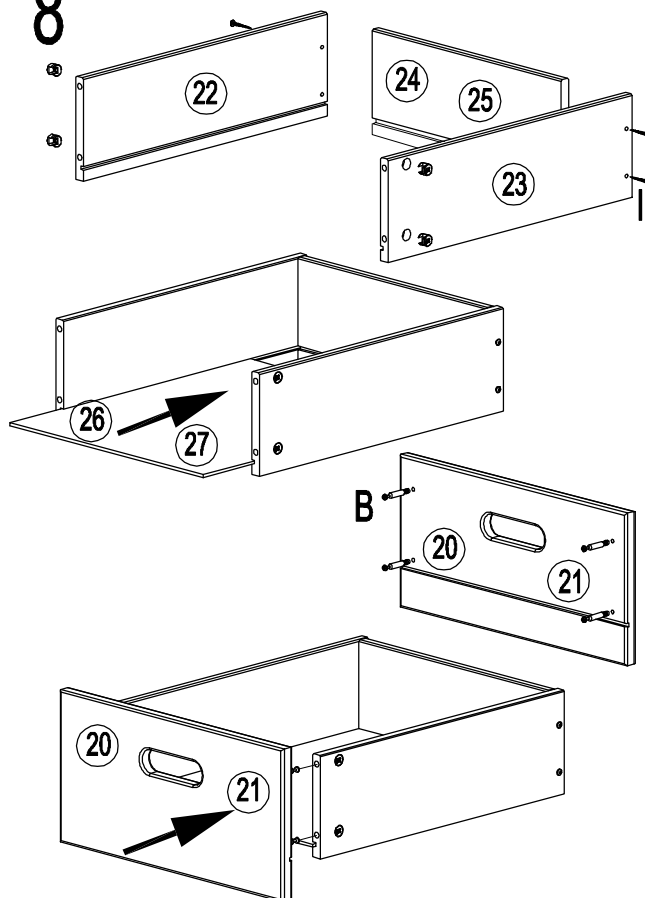

9

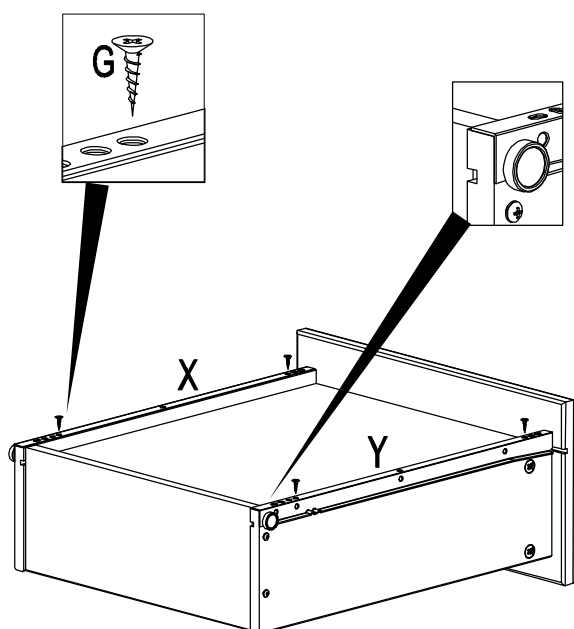

10

