

1

01	X2	02	X2	03	X4	04	X2	05	X2
06	X2	07	X2	08	X4	09	X4	10	X4
11	X14	12	X4	13	X2	14	X2	15	X6
16	X8	17	X6	18	X18	19	X4	20	X1
ST3.5X20		ST4X30		ST4X10		ST4X6.5		Ø 2.5	

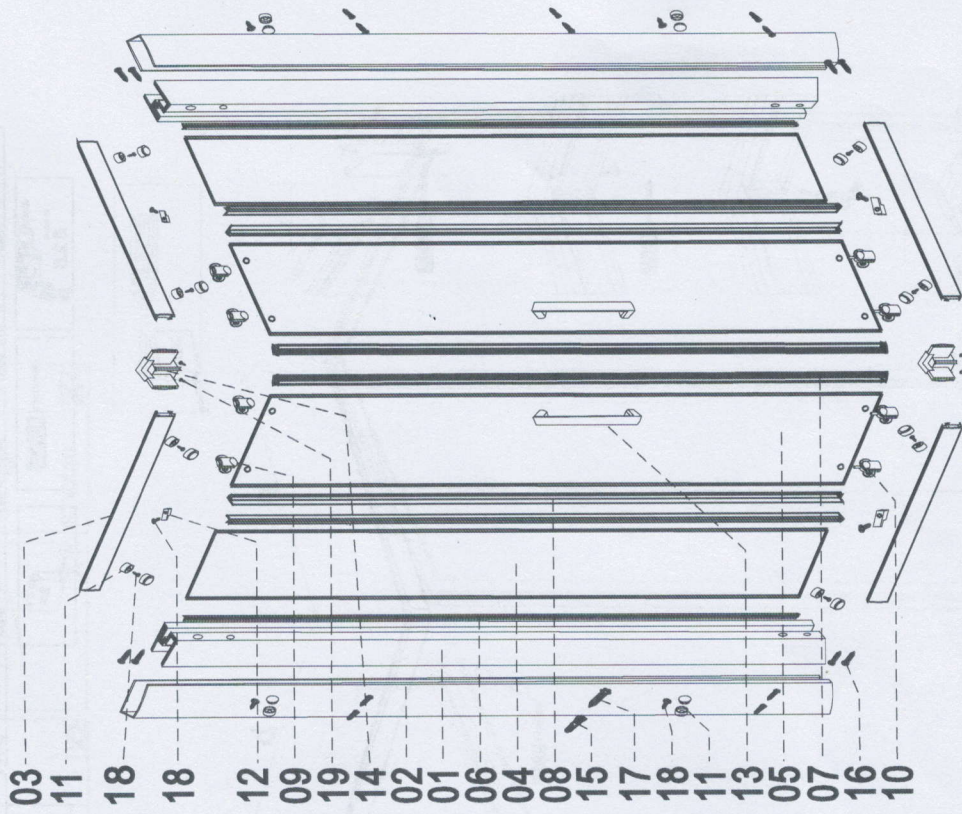

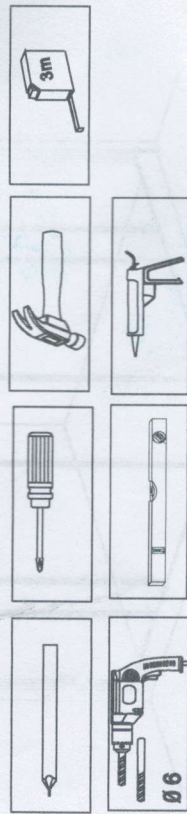
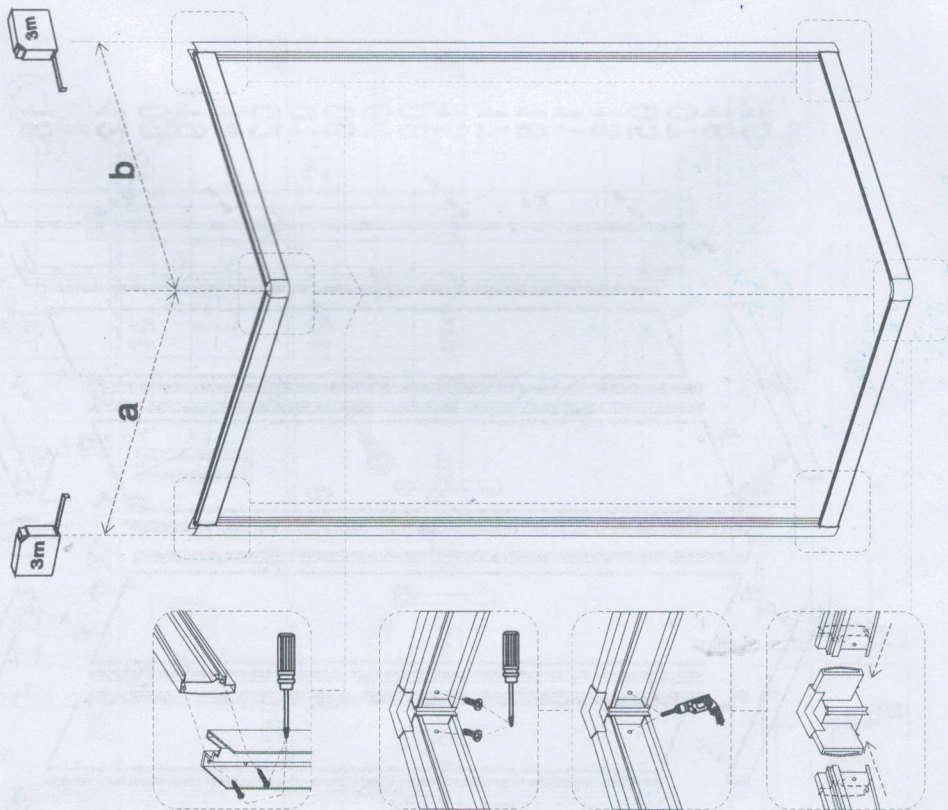
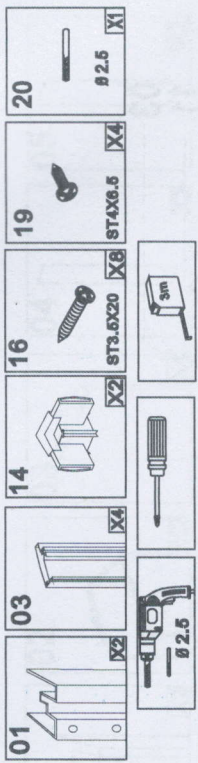

4

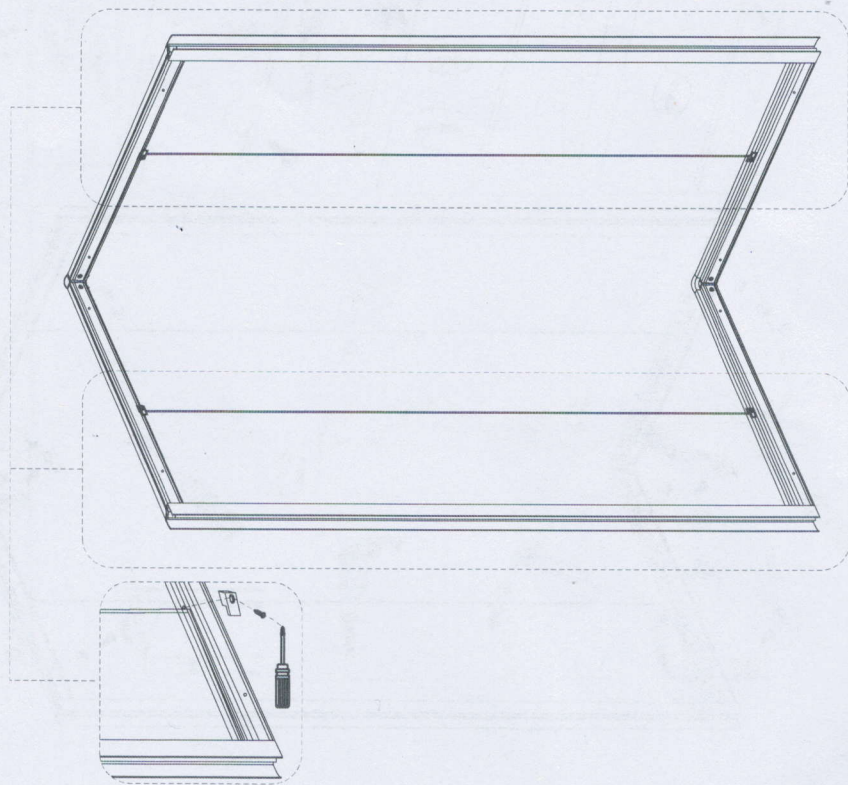
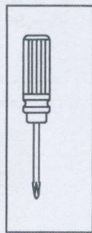
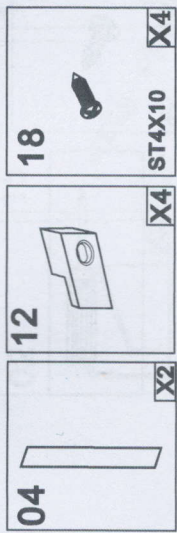

5

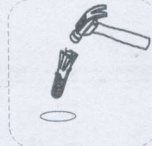
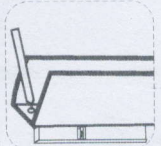
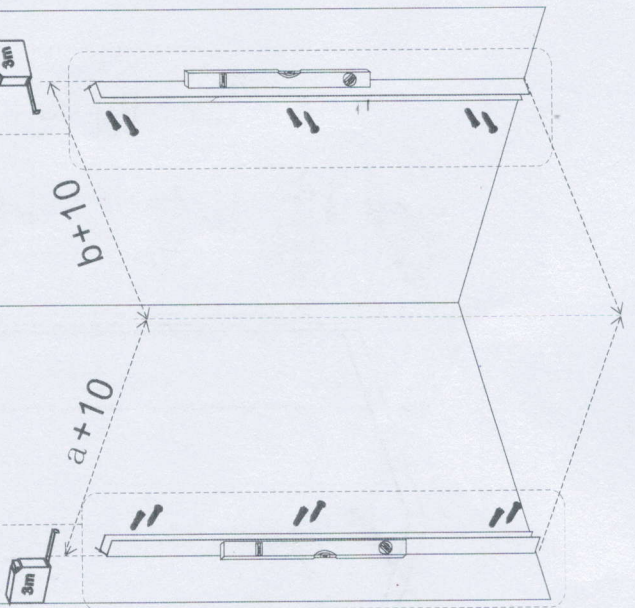
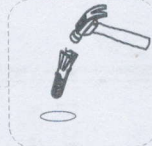
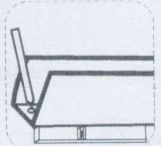
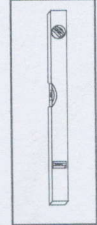
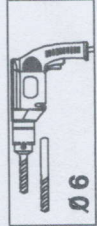
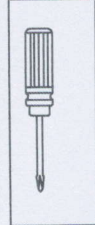
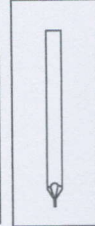
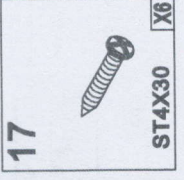
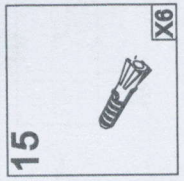
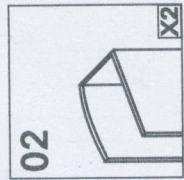
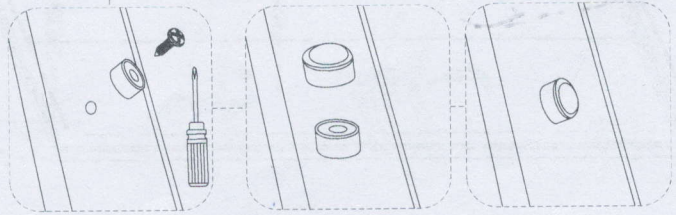
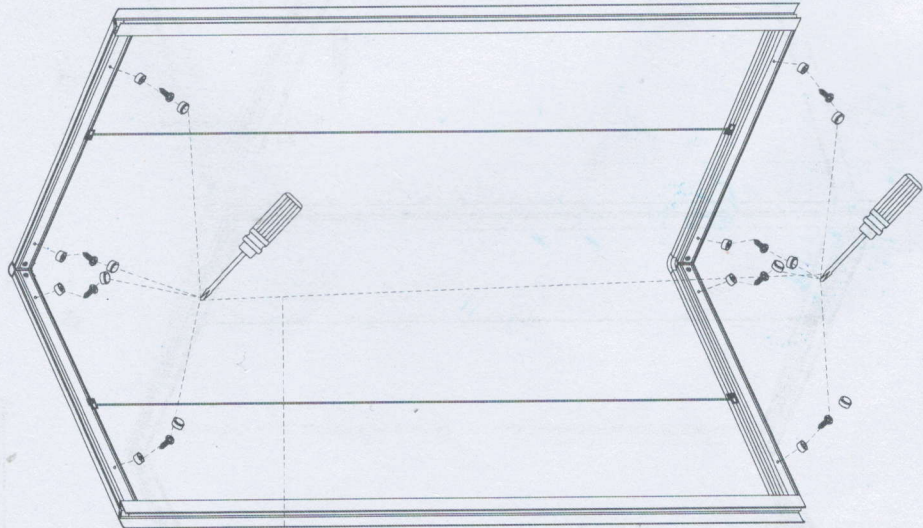
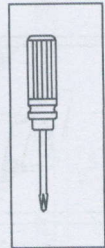
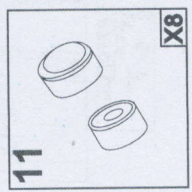

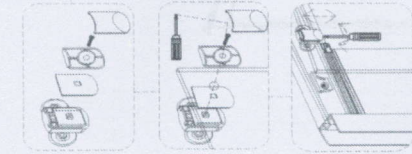
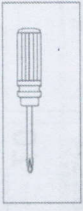
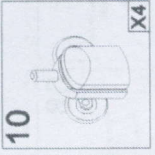
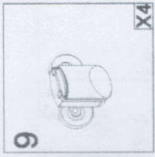
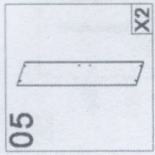
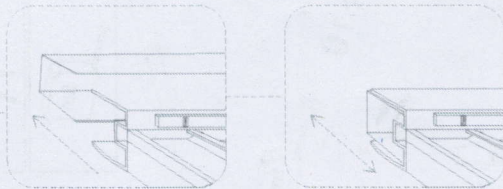
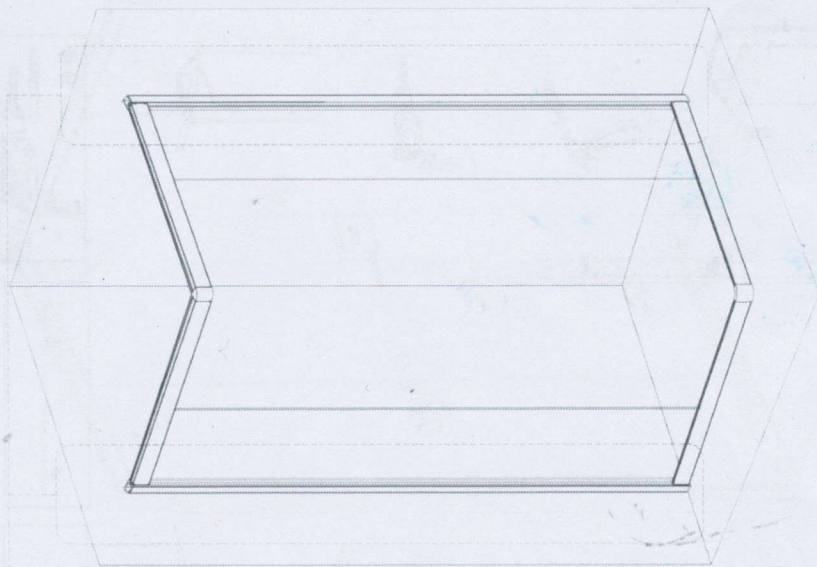
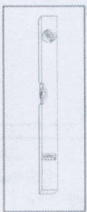

Nota:  
Riregolare la  
ruota verso il  
basso.

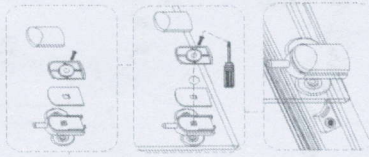
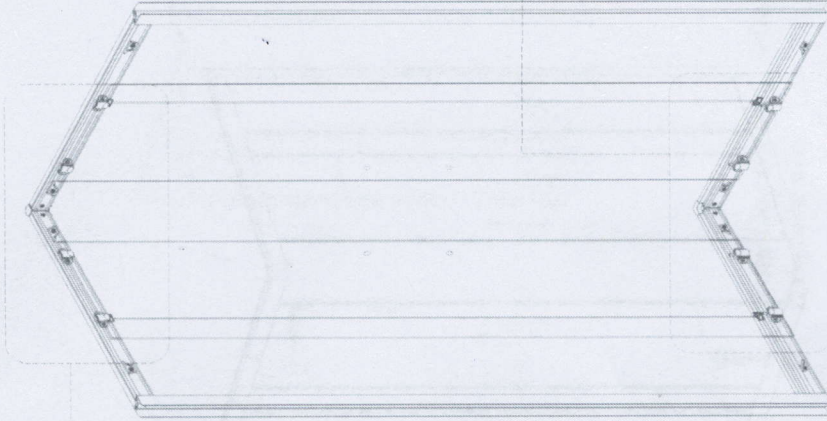

Nota: si consiglia di  
regolare verso l'alto  
le ruote superiori  
per agevolare  
l'inserimento del  
vetro

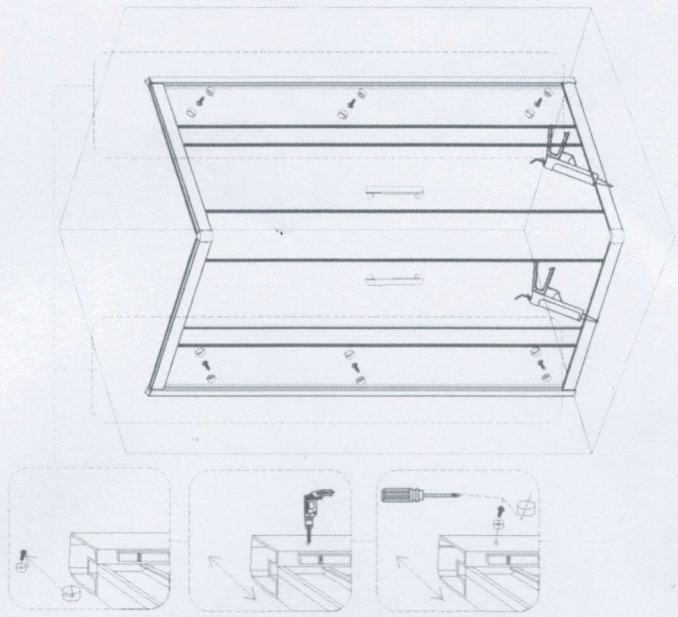
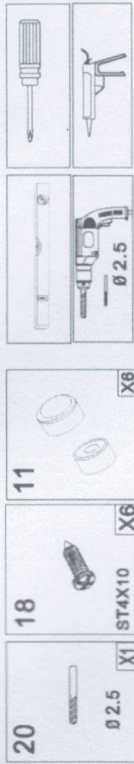

**!** Note: Dopo aver livellato i profili  
fissare le viti **!**

11

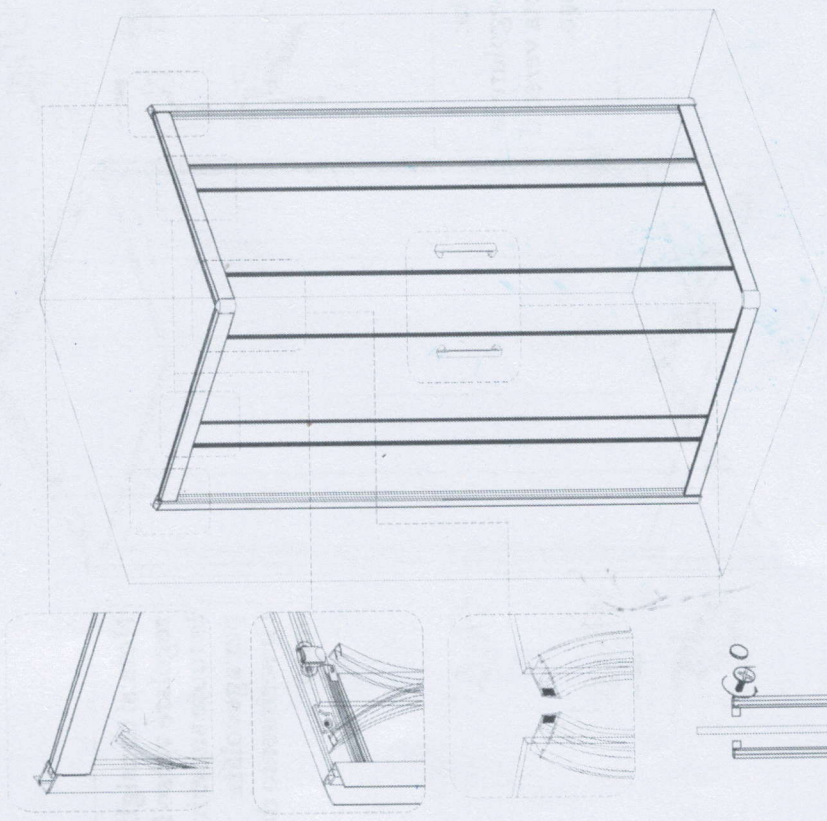
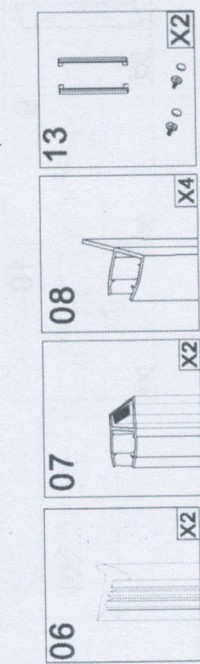

10