

Haylou GT6 真无线蓝牙耳机 使用说明书

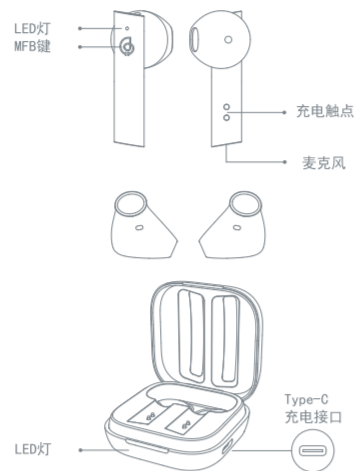

产品介绍



佩戴耳机



将耳机轻轻塞入耳道，调整耳机达到最佳佩戴状态。

通话时，将耳机麦克风朝向嘴部可使通话更清晰。

充电

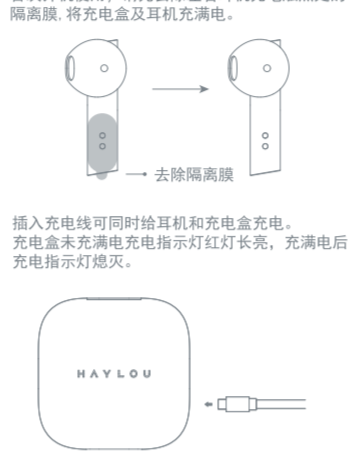

首次开机使用，请先去除左右耳机充电触点处的隔离膜，将充电盒及耳机充满电。

插入充电线可同时对耳机和充电盒充电。充电盒未充满电充电指示灯红灯长亮，充满电后充电指示灯熄灭。

开机

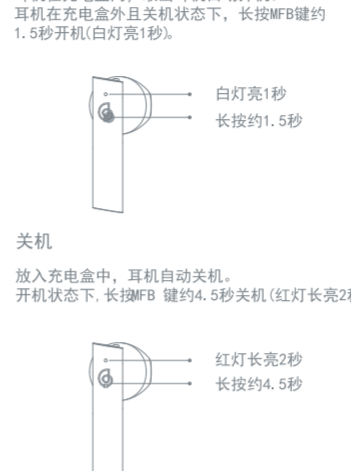

关机

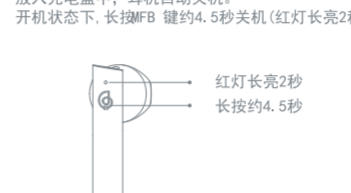

开始使用



单耳/双耳自由切换：两只耳机连接成功后即为双耳连接，将任一耳机放回充电盒关机，另一只耳机进入单耳模式，重新取出即可自动恢复双耳模式。

手动连接：在耳机关机时，手动打开两只耳机，在5秒内耳机开机串联，待双耳机白灯慢闪时，打开设备蓝牙进行连接。

功能说明

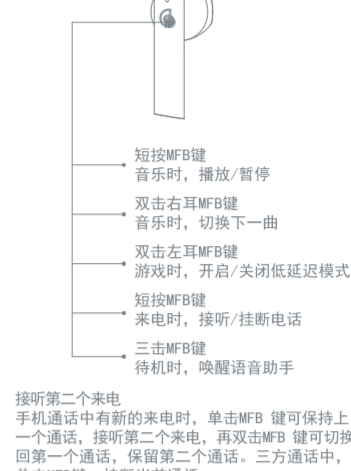

接听第二个来电
手机通话中有新的来电时，单击MFB键可保持上一个通话，接听第二个来电，再双击MFB键可切换回第一个通话，保留第二个通话。三方通话中，单击MFB键，挂断当前通话。

耳机重置

- 1、耳机在充电盒内充电中（常亮红灯或满电亮白灯1分钟内）；
 - 2、同时长按左右耳机触摸键约10s，直到红白灯3次交替闪烁后松开；
 - 3、耳机从充电盒内取出，直到双耳白灯慢闪；
 - 4、清除手机配对记录，按配对步骤，重新完成蓝牙连接即可；
- * 若操作不成功，请重复以上步骤；或登录官方旗舰店，联系客服，查看复位操作视频。
- 耳机一边有声一边无声
极端情况下会出现此类情况，发生后请参考以下操作步骤：
1、将耳机放回充电盒内，重新取出连接使用。
2、参考耳机重置步骤，重新连接蓝牙设备。
充电时遇到的其他情况
1、耳机充满电后，白灯长亮1分钟后熄灭，此时耳机处于满电状态。
2、充电盒没电时，耳机无法充电且保持原来的连接状态。
3、充电盒充满电后，充电指示灯会熄灭。

包装内容物

- 耳机，充电盒，说明书。
- 耳机基本参数
通讯距离：10米（无障碍空旷环境）
电池容量：35mAh（单耳机）
充电时间：约1.5小时
通话时间：约4小时
待机时间：约60小时
输入参数：5V = 100mA
输出参数：5V = 150mA
充电时间：约2小时
电池容量：310mAh
电池类型：锂离子聚合物
无线连接：蓝牙5.2
- 充电盒基本参数
输入参数：5V = 500mA
输出参数：5V = 150mA
充电时间：约2小时
电池容量：310mAh
电池类型：锂离子聚合物
- 日常维护
请勿佩戴耳机洗澡、淋浴，放入洗衣机及在非常潮湿情况等潮湿环境使用。每次正常使用后，请用干布等工具擦干耳机上的汗渍或者雨水，可以有效延长耳机的使用时长。

注意事项

- 警告
- 1、请勿以任何理由拆开、维修或改装耳机，否则可能会导致起火甚至彻底损坏本产品。
 - 2、请勿将设备置于温度过低或过高（0°C以下或45°C以上）的环境下。
 - 3、使用产品指示灯时，请避开儿童或动物的眼睛。
 - 4、请勿在雷雨天气下使用本产品，雷雨可能导致设备工作异常，并增加触电的危险。
 - 5、请勿使用酒精或其他挥发性液体擦拭本产品。
 - 6、请勿将本产品与液体接触。
- 注意
- 1、使用前请仔细阅读本使用说明书并妥善保管。
 - 2、首次使用时，请先将本产品充满电。
 - 3、如果产品长期（超过2个星期）不用，请对其充电。
 - 4、必须选择正规厂家生产且经过国家CCC认证的充电器。
 - 5、长时间连续使用耳机有损听力，请合理控制使用时间及音量。
 - 6、使用耳机会降低对外界声音的感知力，请不要在可能威胁到安全的环境中使用耳机。

产品中有害物质的名称及含量

部件名称	有害物质					
	铅 (Pb)	汞 (Hg)	六价铬 (Cr(VI))	多溴联苯 (PBB)	多溴二苯醚 (PBDE)	其他
耳机主体	○	○	○	○	○	○
电池	○	○	○	○	○	○
耳罩	○	○	○	○	○	○
充电盒	○	○	○	○	○	○

本表格依据SJ/T 11364的规定编制。
0：表示该有害物质在该部件所有均质材料中的含量均在 26572规定的限量要求以下。
X：表示该有害物质在该部件所有均质材料中的含量超出GB/T 26572规定的限量要求。

Haylou蓝牙耳机售后服务

- Haylou蓝牙耳机售后服务承诺，严格按照《中华人民共和国消费者权益保护法》、《中华人民共和国产品质量法》实行售后三包服务，服务内容如下：在三包有效期内，您可凭购物凭证依照本规定享受免费的修理、更换、退货的权利。
- 1、自您购买之日起7日内，本产品出现故障，由Haylou售后服务中心确定为产品质量问题，可享受修理、更换、退货的服务。
 - 2、自您购买之日起15日内，本产品出现故障，由Haylou售后服务中心确定为产品质量问题，可享受修理或更换的服务。
 - 3、自您购买之日起12个月内，本产品出现故障，由Haylou售后服务中心确定为产品质量问题，可享受修理的服务。

三包凭证

产品信息	用户姓名	购买日期
用户姓名	联系电话	验证码
购买地址	用户地址	
购买时间	销售单位	注册编号

Haylou GT6 性能故障表

名称	性能故障
蓝牙耳机	1. 使用过程中听不到声音。 2. 通话过程中，对方听不到声音。 3. 无法充电。

非保修条例

- 1、使用造成的正常磨损脏污如：刮痕、颜色改变；因接触化学试剂、接触尖锐物体、摔落挤压等人为导致损坏。
- 2、未经授权的维修、使用、碰撞、疏忽、滥用、进水、事故、改造正确的使用非本产品配件或篡改、涂改标识、防伪标记。
- 3、已超过三包有效期。
- 4、因不可抗力造成的损坏。
- 5、不符合《性能故障表》所列性能故障的情况。
- 6、因人为原因导致本产品及其配件产生《性能故障表》所列性能故障。

说明书中的产品、配件、用户界面等插图均为示意图，仅供参考。由于产品的更新和升级，产品实物与示意图可能略有差异，请以实物为准。

售后服务与支持

- 保修期：
自产品购买之日起12个月（请妥善保管购买凭证）
免费服务：
在产品保修期内，凡属产品本身质量问题引起的故障，请用户凭购买凭证与经销商取得联系以享受售后服务。
如有任何产品损害或瑕疵非可归责于产品质量本身，则不在保修范围内。有下列情形者不属于保修范围：
1、因火灾、地震、雷击、异常电压、环境因素而发生之故障或损毁。
2、自行或委托未经原厂授权维修之厂商拆卸、改装或更换非原厂零件。
3、未按使用手册操作或因人为使用不当而造成环境，如产品浸水、腐蚀、掉落、挤压或暴露在异常温湿度环境下。
- 若有售后服务需求，请联系Haylou客服
制造商：东莞利捷电子科技有限公司
制造地址：广东省东莞市南城街道
网址：www.haylou.com
服务热线：4008-555-083



Haylou GT6 True Wireless Earbuds User Manual



Overview

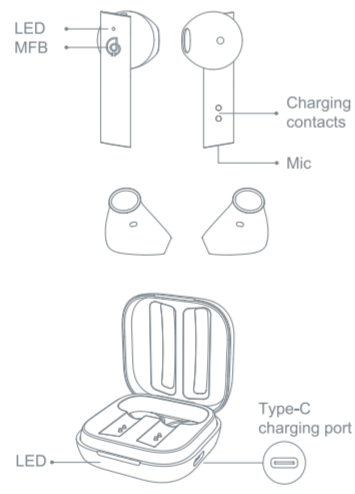

How to Wear

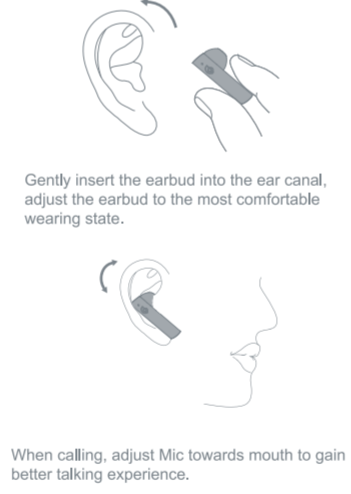

Gently insert the earbud into the ear canal, adjust the earbud to the most comfortable wearing state.

When calling, adjust Mic towards mouth to gain better talking experience.

How to Charge

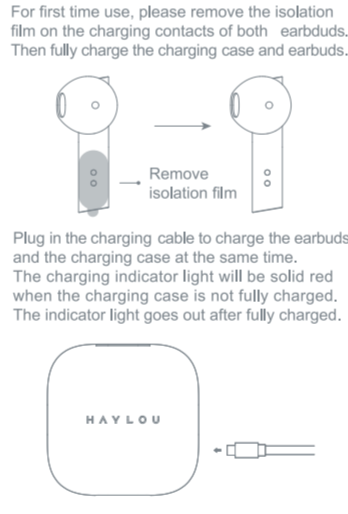

Plug in the charging cable to charge the earbuds and the charging case at the same time. The charging indicator light will be solid red when the charging case is not fully charged. The indicator light goes out after fully charged.

Power-on

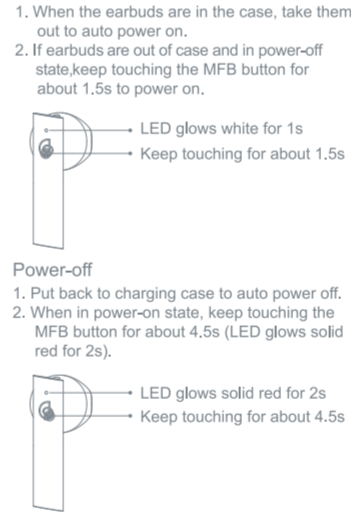

LED glows white for 1s
Keep touching for about 1.5s

Power-off

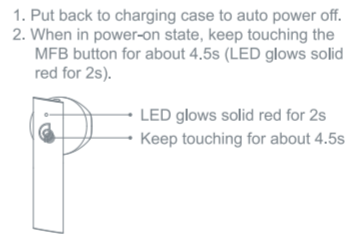

LED glows solid red for 2s
Keep touching for about 4.5s

How to Pair

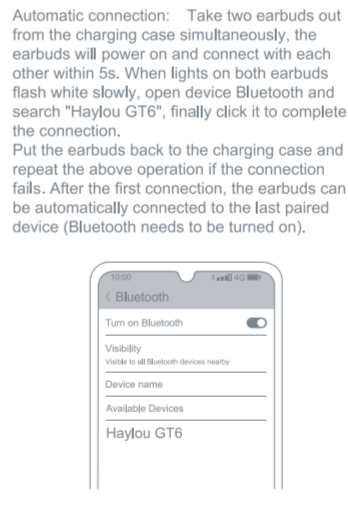

Automatic connection: Take two earbuds out from the charging case simultaneously, the earbuds will power on and connect with each other within 5s. When lights on both earbuds flash white slowly, open device Bluetooth and search "Haylou GT6", finally click it to complete the connection.
Put the earbuds back to the charging case and repeat the above operation if the connection fails. After the first connection, the earbuds can be automatically connected to the last paired device (Bluetooth needs to be turned on).

Switch between mono and stereo mode:
It is stereo mode after two earbuds are successfully connected. Put one back into the case to power off, the other will enter mono mode. Or pick it up again to resume stereo mode.
Manual connection:
When earbuds are turned off, manually turn on the two earbuds. Wait 5s for the earbuds to turn on and connect with each other. When lights on both earbuds flash white slowly, turn on device Bluetooth to connect.

Functions

- Short press MFB button
Play/Pause music
 - Double click right MFB button
Skip track forward
 - Double click left MFB button
Turn on/off low latency mode when playing games
 - Short press MFB button
Answer/End call
 - Triple click MFB button
Summon voice assistant when standby
- Answer the Second Call
When there is a new incoming call during a call, click the MFB button to keep the first call and answer the second call, then double click the MFB button to switch back to the first call and keep the second call. During a three-party call, click the MFB button to hang up the current call.

Factory Setting

1. The earbuds are charging in the charging case (light glows solid red or white after fully charged within 1 minute).
 2. Long press the two earbuds simultaneously for about 10s, release after LED alternately flashes red and white 3 times.
 3. Take the earbuds out from the charging case until LED flashes white slowly.
 4. Clear phone pairing records, follow the pairing steps to complete Bluetooth connection.
- Audio only Outputs from Single Earbud
It's unusual indeed, please refer to the following operation steps if the situation occurs:
1. Put the earbuds back into the charging case, and then take them out again to connect.
2. Refer to the reset steps to reconnect the Bluetooth device.
- Other Charging Problems
1. White indicator light goes out after 1 minute. The earbuds have been fully charged.
2. When the charging case is out of power, the earbuds cannot be charged and keep the original connecting status.
3. The indicator light will go out after the charging case is fully charged.

Package List

- Earbuds, charging case, user manual.
- Basic Parameters(earbuds)
Operation range: 10m (open space with no obstacle)
Battery capacity: 35mAh(single earbud)
Charging time: approx. 1.5h
Talk time: approx. 4h
Standby time: approx. 60h
Input parameter: 5V = 100mA
Battery type: Li-Ion
Bluetooth version: V5.2
- Basic Parameters(charging case)
Input parameter: 5V = 500mA
Output parameter: 5V = 150mA
Charging time: approx. 2h
Battery capacity: 310mAh
Battery type: Li-Ion

Caveats

- Warning
1. Do not disassemble, repair or modify the product for any reason, as this may cause fire or even completely destroy the product.
 2. Do not expose the product to environments where the temperature is too low or too high (below 0°C or above 45°C).
 3. Keep the indicators away from the eyes of children and animals while using the earphones.
 4. Do not use this product during thunderstorms. Thunderstorms may cause the product to malfunction and increase the risk of electric shocks.
 5. Do not wipe and clean the earphones or their case with alcohol or other volatile liquids.
 6. Avoid any contact with liquids.
- Note
1. Please read this user manual carefully before using the product and please properly store it.
 2. When using for the first time, please fully charge this product.
 3. Please charge the product, in case it has not been used over two weeks.

Warning

4. Please use certificated charger.
 5. Do not wear earphones for a long time to protect your hearing.
 6. Do not wear earphones in any situations with potential risks as wearing them may reduce your perception to the outside world.
- FCC Requirement
Changes or modifications not expressly approved by the party responsible for compliance could void the user's authority to operate the equipment.
This device complies with Part 15 of the FCC Rules. Operation is subject to the following two conditions:
1. This device may not cause harmful interference;
2. This device must accept any interference received, including interference that may cause undesired operation.
- Daily maintenance
Please do not shower with earbuds. Do not wear them in rainy day. Do not leave them in washing machine or other extreme situations. Clean them with dry cloth.

Warranty Card

Warranty Period
12 months after you purchase this item. (or you may inquire your local shopper for more details.)

Free Service
Supposing any defects caused by quality issues occur within the warranty period, please take this warranty card and purchase receipts to your distributor for free exchange service.

Model Number	Date of Purchasing
User's Name	User's Phone
User's Address	Shop's Name
Shop's Address	Shop's Address
Comments	

Free exchange service will not be accessed under following circumstances:
1. Damages caused by unauthorized disassembly.

Manufacturer: Dongguan Lisheng Electronic Co., Ltd.
Address: Room 401-410, Building 1, No. 86 Hongtu Road, Nancheng District, Dongguan City, Guangdong, China