

Cybovac™

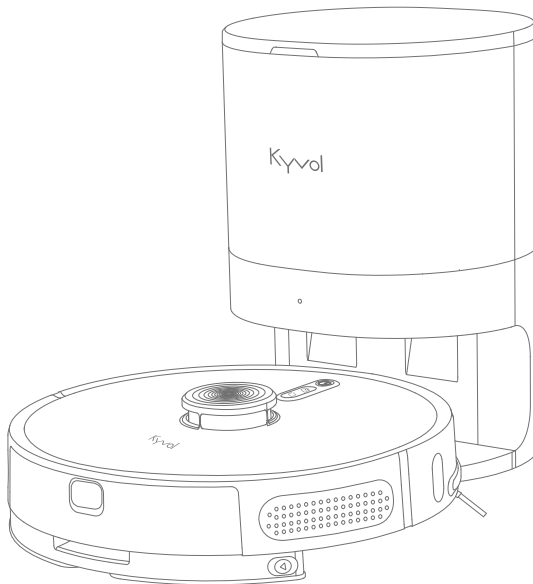

LDS Robot Vacuum Cleaner with Automatic Dust Emptying Base User Manual

S31

CONTENTS

IMPORTANT SAFETY INSTRUCTIONS	01
BATTERY	02
PACKING LIST	03
PRODUCT OVERVIEW	04
LDS ROBOT VACUUM CLEANER	04
AUTOMATIC DUST EMPTYING BASE	05
REMOTE	05
GETTING STARTED	06
ROBOT VACUUM CLEANER	06
AUTOMATIC DUST EMPTYING BASE	06
OPERATION GUIDE	07
CHARGING	07
CLEANING PREPARATION	08
OPERATION OF LDS ROBOT CLEANER	09
AUTOMATIC DUST EMPTYING BASE GUIDE	13
MAINTENANCE AND CARE	14
CLEANING AND REPLACEMENT FREQUENCY	15
DUST BIN AND FILTER	16
SIDE BRUSHES	18

MAIN BRUSH	19
SENSORS AND CHARGING CONTACTS	20
ROBOT TOP	21
OMNI-DIRECTIONAL WHEEL	21
WATER TANK AND MOPPING PAD	22
IR LENS AND CHARGING/DUST COLLECTING CONTACTS	23
FAN FILTER SUPPORT	24
SPECIFICATIONS	24
TROUBLESHOOTING GUIDE	25

IMPORTANT SAFETY INSTRUCTIONS

READ THESE INSTRUCTIONS BEFORE USING THIS CYBOVAC.

IT IS INTENDED FOR HOUSEHOLD USE ONLY.

- Users should only operate the Cybovac once they have understood all the following important safety instructions. This appliance is not intended for use by persons (including children) with reduced physical, sensory or mental capabilities, or lack of experience and knowledge, unless they have been given supervision or instruction concerning use of the appliance by a person responsible for their safety.
- Children should be supervised to ensure that they do not play with the appliance.
- The appliance is only to be used with the power supply unit provided with the appliance. Only use original parts made by Kyvol and contact us directly if you need an accessory or replacement part.
- DO NOT operate the Cybovac on or close to wet surfaces when using it to vacuum dust.
- DO NOT operate the Cybovac close to unattended babies or children.
- DO NOT use the Cybovac to vacuum burning or smoking objects such as cigarettes or hot ashes etc. This is a fire hazard.
- DO NOT place anything on the Cybovac or hit against it.
- DO NOT operate the Cybovac with wet hands.
- DO NOT use if the power cable or plug appears to be damaged.
- DO NOT use the Cybovac to clean up flammable liquids such as oil and paint.
- DO NOT apply any fragrance or scented products to the Cybovac's filter. This is a fire hazard.
- DO NOT use the Cybovac in rooms with open fireplaces, lit candles or fragile objects on the floor.
- DO NOT use your Cybovac in areas with exposed electrical outlets.
- We recommend you test the Cybovac on a small area before general use. This is to ensure that the appliance does not scratch or damage the floor.
- Please ensure that all individuals are aware that your Cybovac is in use. This is to avoid any accidents.
- Ensure that the **Dust Bin** or the **Filter** are firmly in place before using the Cybovac.
- Remove all power cords and other loose items which could get tangled into the appliance from the floor before using the Cybovac.
- Remove all loose objects from the floor before using your Cybovac to prevent its openings from being blocked. This includes clothing and loose papers.

- Keep the Cybovac free of bunches of lint, hair and anything that may reduce airflow.
- Use two hands when moving or carrying the Cybovac.
- Clean your Cybovac with a dry or damp cloth.
- The power plug for the **Automatic Dust Emptying Base** must be removed from the socket before cleaning or maintaining.
- Cleaning and maintenance shall not be done by the children.
- Unplug the **Automatic Dust Emptying Base** when not in use for extended periods of time.
- Kyvol will accept no liability or responsibility for fires, explosions or electrical shocks caused by improper operation, dismantling the Cybovac or by not adhering to the above safety instructions.

BATTERY

- The Cybovac is powered by an internal, rechargeable Li-ion battery.
- This appliance contains battery that is only replaceable by skilled persons. DO NOT attempt to disassemble or replace the battery yourself as this may cause overheating, fire or injury.
- DO NOT expose the battery to any direct heat source, including fire or direct sunlight. This is a fire hazard.
- DO NOT dispose of the Cybovac or the battery pack in fire, water or other liquids. This is to avoid any explosion hazards.
- DO NOT dispose of the Li-ion battery in your household waste. Dispose of it following your local environmental laws and regulations.

PACKING LIST



LDS Robot Vacuum
Cleaner S31



Automatic Dust
Emptying Base
(Automatic Dirt Disposal)



Remote



Cleaning Brush
(In the Dust Bin)

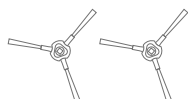

Spare Side Brush × 2



Water Tank (with
Washable Mopping Pad)



Spare Washable
Mopping Pad

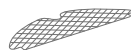

Disposable Mopping
Pad × 10

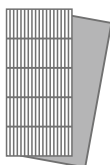

Spare HEPA
and Sponge

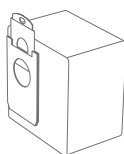

Spare Dust Bag × 2

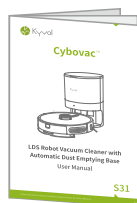

User Manual

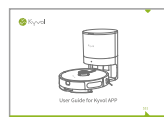

User Guide for
Kyvol APP

PRODUCT OVERVIEW

LDS ROBOT VACUUM CLEANER

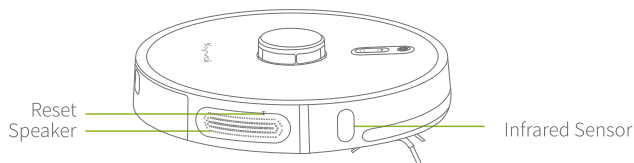
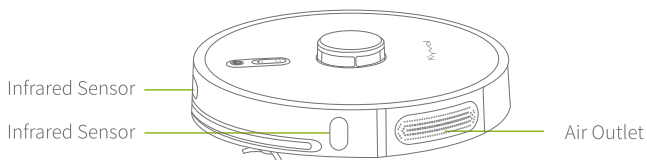
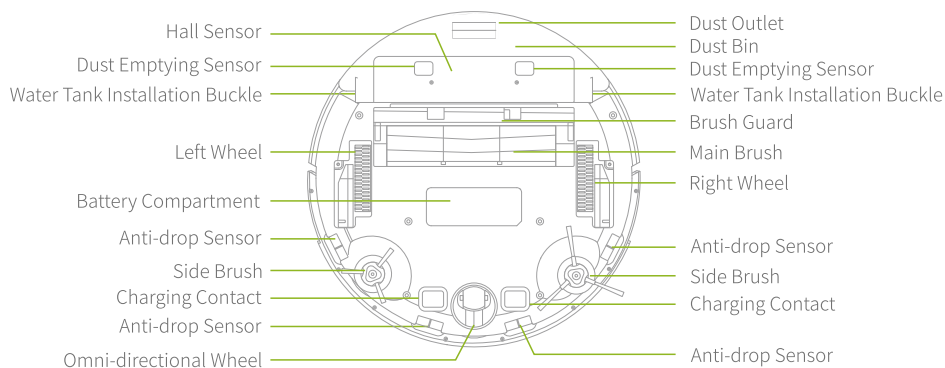
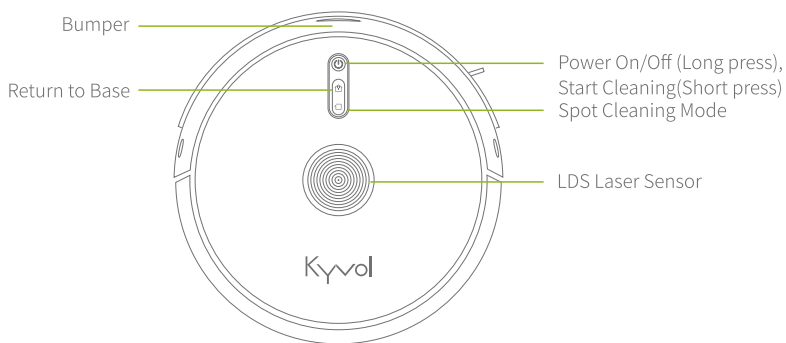

AUTOMATIC DUST EMPTYING BASE

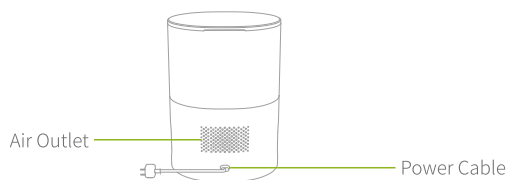
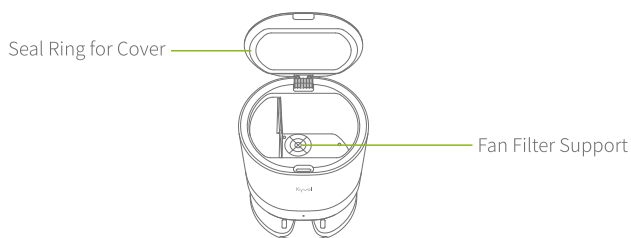
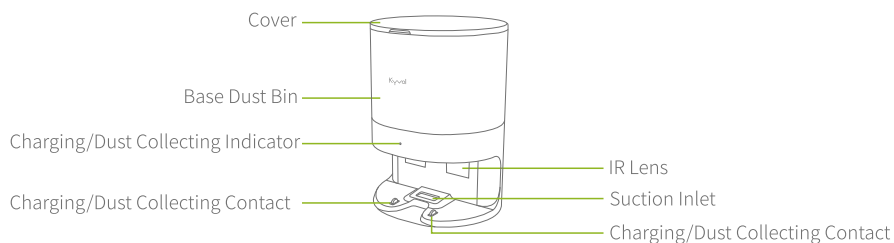

REMOTE

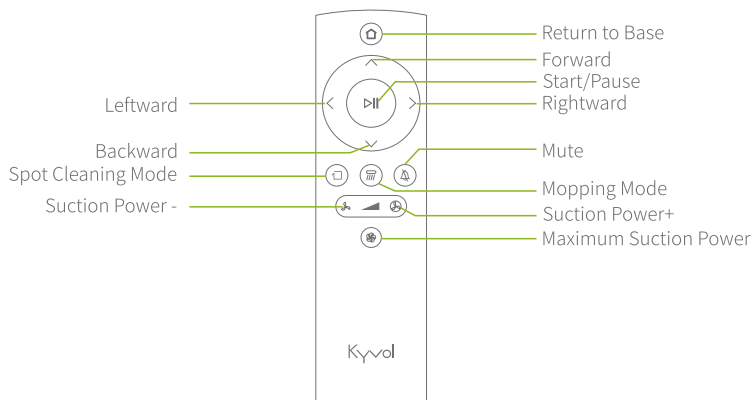

GETTING STARTED

LDS ROBOT VACUUM CLEANER

Remove the protective material located on both sides of the Cybovac.



Install the AAA batteries into the **Remote**.

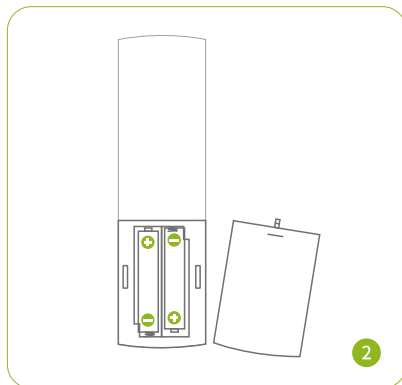

AUTOMATIC DUST EMPTYING BASE

Make sure that there is a clear space at least 1.2m in front and a clear space at least 0.5m on both sides of the base.

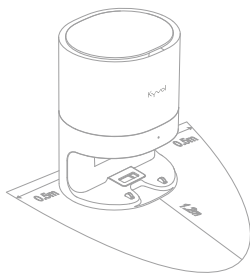

! Notes:

1. Ensure the base is powered, which is indicated by a pulsing white power indicator on it.
2. Place the base where the Cybovac can easily access.
3. Ensure that the base is plugged in to avoid that the Cybovac can't find the base when its battery power gets low.



OPERATION GUIDE

CHARGING

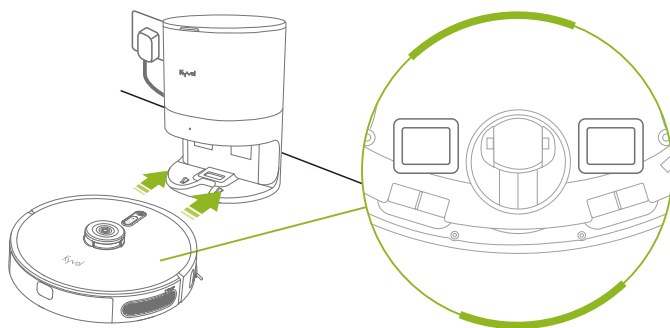
Please fully charge your Cybovac before your first use. Manually align the **Charging Contacts** on the bottom of the Cybovac with those on the base.



Indicators:

<p>Charging:</p>  <p>Solid orange</p>	<p>Fully Charged:</p>  <p>Pulsing white</p>	<p>Low Battery:</p>  <p>Pulsing orange</p>
--	--	---

! Notes:

1. It takes the Cybovac up to 6.5 hours to reach a full charge. This will provide up to 240 minutes cleaning time on hard floors with the medium suction power.
2. To extend the battery's lifespan, recharge the Cybovac at least once every 3 months if not using it for long periods of time.
3. Do not open the battery compartment and replace the battery by yourself. If the Cybovac won't charge, please contact us at support@kyvol.com for further assistance.

CLEANING PREPARATION

Tidy the area before using the Cybovac for a worry-free cleaning experience.

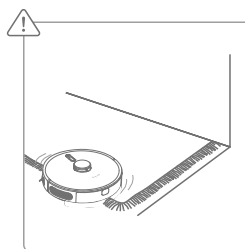
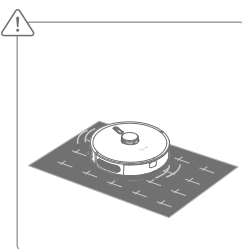
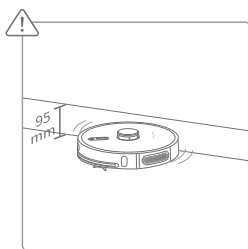
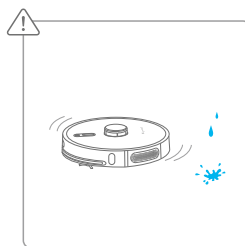
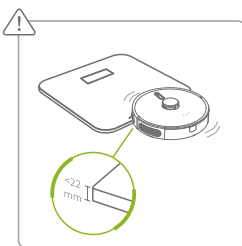
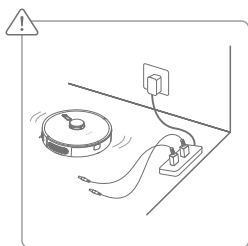

! Notes:

1. Remove any objects from the floor that may entangle the Cybovac, such as power cords, ropes, etc.
2. The Cybovac will mount all objects that are less than 22mm thick. If you do not wish for such items to be cleaned, please remove them from the area.
3. Do not operate the Cybovac on a wet surface when using it to vacuum dust.
4. Keep the Cybovac away from furniture that is raised 95mm or less from the ground (because the thickness of Cybovac is about 95mm). This is to ensure that the appliance doesn't get stuck.
5. The Cybovac may not operate on certain dark colored surfaces as the Anti-drop Sensors may regard this as an edge.
6. Fold the tasseled edges underneath the area rugs to prevent tangling the Cybovac.

OPERATION OF LDS VACUUM CLEANER

Power On

Option 1: Long press  until you hear a startup voice prompt to power it on. The power indicator will turn a solid white.

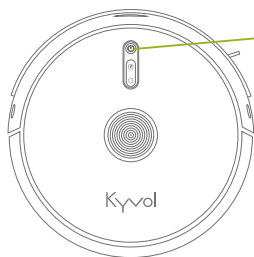

Option 2: The robot will boot automatically when charging.

Power Off

Long press  until you hear a shutdown voice prompt to power it off. The white power indicator will turn off slowly.

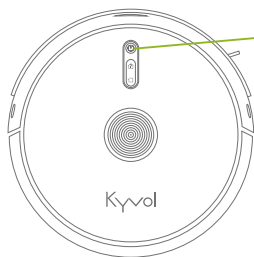



Standby Mode

After powering on, the robot will enter **Standby Mode** when there is no cleaning command, and the power indicator will be pulsing white.

The robot will return to the base automatically after 10 minutes in **Standby Mode**.







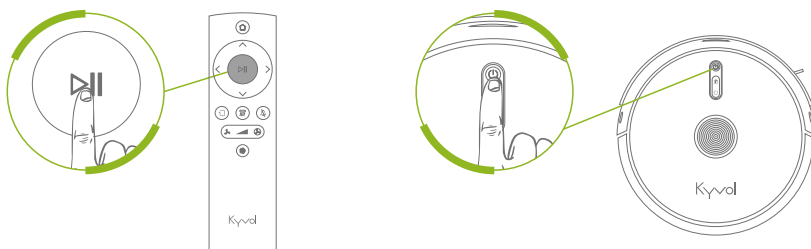

Cleaning Modes

Auto Cleaning Mode

After powering on, press  on the Cybovac or  on the remote to begin **Auto Cleaning Mode**.

This will then instruct the Cybovac to clean all accessible space with the medium suction power (default level) until cleaning up the current area or until the battery power becomes low.

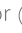

- * Press  on the Cybovac or  on the remote to pause the cleaning process; press again to resume.
- * Press     on the remote to manually adjust the direction of the Cybovac.
- * During the cleaning process, press  on the Cybovac or  on the remote to get it back to the base.
- * Press  on the remote to adjust the levels of the suction power. Press  for the maximum level of the suction power.

Tips:

- 1 When the battery power gets low, the Cybovac will automatically return to the base. We highly recommend keeping the Cybovac connected to the base at all times, and fully charging it before operating.
- 2 If the battery is low, the Cybovac won't be able to perform the scheduled cleaning that you set for **Auto Cleaning Mode**, and you will hear a voice prompt. Please charge the Cybovac timely.
- 3 **It is recommended to control the robot back to the dust emptying base before the cleaning to let the robot memorize the starting point. Do not move or pick up the robot when it is cleaning, otherwise the starting point and the map will be invalid.**

Spot Cleaning Mode

This cleaning mode aims to intensively clean a specific area.

Step 1:



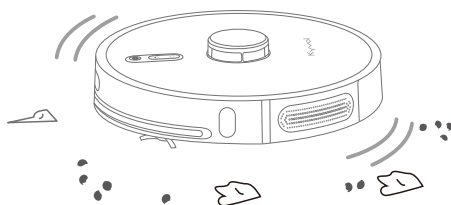



Locate an area that needs intensive cleaning, such as one with lots of dust. Move the Cybovac to the center of this area.

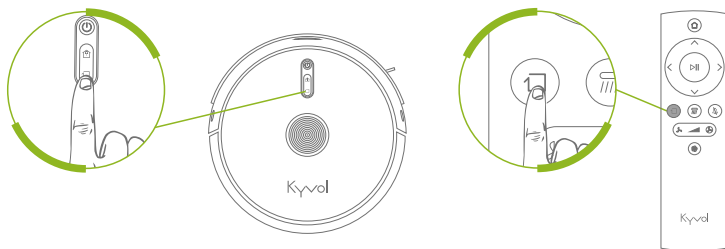

Step 2:

Press  on the Cybovac/remote to start the spot cleaning process. It will move in a square pattern. The maximum area of the square is approximately 2.25m².



* Press  on the Cybovac or  on the remote to pause the cleaning process, then press     on the remote to manually adjust the direction of the Cybovac.

* During the cleaning process, press  on the Cybovac or  on the remote to get it back to the base.

Mopping Mode

Step 1:

Fill the **Water Tank** with water.

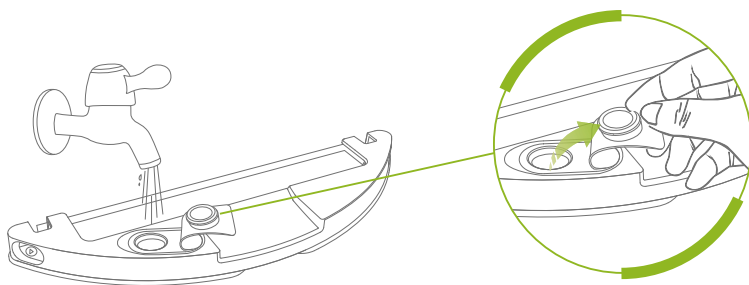

Step 2:

Align the **Water Tank** with the **Water Tank Installation Buckles** on the bottom of the Cybovac and install the **Water Tank**.

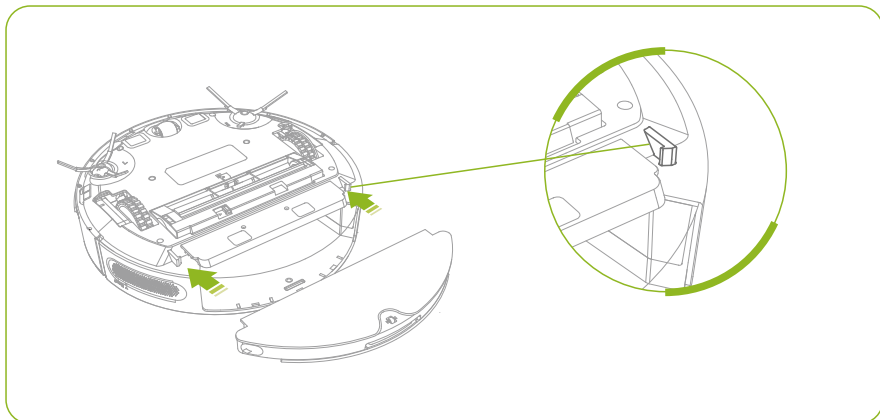

Step 3:

Press  on the remote to start **Mopping Mode**; press other mode buttons on the remote to start sweeping and mopping simultaneously under the mode.

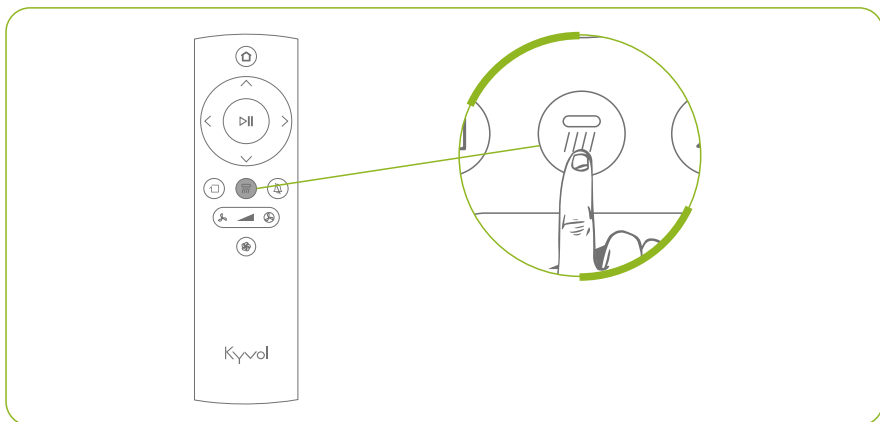

! Notes:

1. Press the buttons on both sides of the **Water Tank** and take out the **Water Tank** when the Cybovac is not in use.
2. Only use water in the **Water Tank**. Do not use any cleaning solution, even natural ones, which will cause damage to the Cybovac.
3. Do not attempt to mop carpeted floors.
4. The Cybovac cleans best on smooth hard surfaces and may not perform as well on uneven or rough surfaces.
5. Do not leave the Cybovac unattended when using it to mop the floor.

Auto Carpet Boost

The Cybovac will automatically increase its suction power on carpet to provide a deeper clean. When on a hard surface, it will return to the medium suction power to provide the optimal amount of suction and save battery power.

Tip:

If the level of suction power is already at the maximum level before cleaning carpet, the Cybovac will continue to use this amount of power.

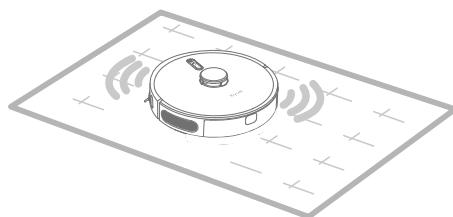

Other Functions

Go to **Kyvol** App to explore more functions of the Cybovac, such as **Area Cleaning Mode**, **No-Go Zones**, **Scheduled Cleaning**, etc.

AUTOMATIC DUST EMPTYING BASE GUIDE

Automatic Dust Emptying Base contains both dust collection and charging functions.

Tips:

- 1 By default, the robot will return to the base to complete dust collection and then recharge automatically after every cleaning.
- 2 When the robot is installed with the **Water Tank**, the dust collection cannot be performed. Please remove the **Water Tank** before dust collection.
- 3 You may go to **Kyvol** App to set the dust emptying frequency, including **Never Emptying Dust**, **Emptying Dust after 1 Cleaning Session**, etc.

Replacement Of The Dust Bag

The fast flashing orange indicator on the **Base Dust Bin** indicates the full dust bag, or you may replace the dust bag following the app instructions. It is recommended to replace the dust bag once every 4-8 weeks.

Step 1:

Open the **Cover**.

Step 2:

Pull up the **Dust Bag Handle** to remove the **Dust Bag**.

Step 3:

Replace with a new **Dust Bag**.

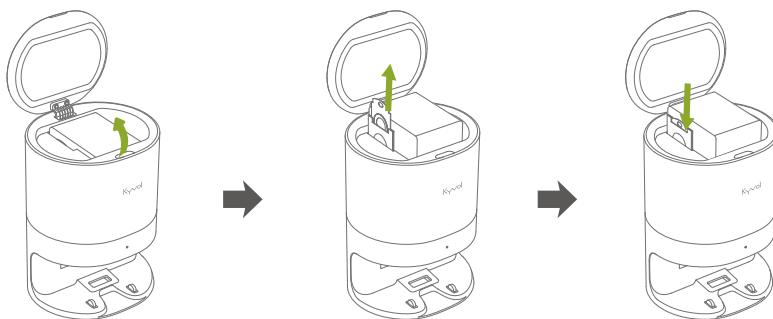

MAINTENANCE AND CARE

For the optimal performance, we recommend a regular maintenance check and cleaning of some parts of the Cybovac.

CLEANING AND REPLACEMENT FREQUENCY

Part	Cleaning Frequency	Replacement Frequency
Dust Bin	After each use	/
Filter	Once per week (Twice per week if you have pets)	Every 2 months
Side Brush	Once per week	Every 3-6 months or when it's worn visibly
Main Brush	Once every 2 weeks	Every 6-12 months or when it's visibly worn
Brush Guard	Once per month	/
Sensors	Once per month	/
Charging Contacts	Once per month	/
Omni-directional Wheel	Once per month	/
Water Tank	After each use	/
Mopping Pad	After each use	When it's visibly worn
Dust Bag	/	Every 4-8 weeks or when it is full
IR Lens	Once per month	/
Charging/Dust Collecting Contacts	Once per month	/
Fan Filter Support	Once per month	/

DUST BIN AND FILTER

Please empty the **Dust Bin** after each use and clean the **Filter** regularly.

Step 1:

Press and hold the latch down to pull the **Dust Bin** out.

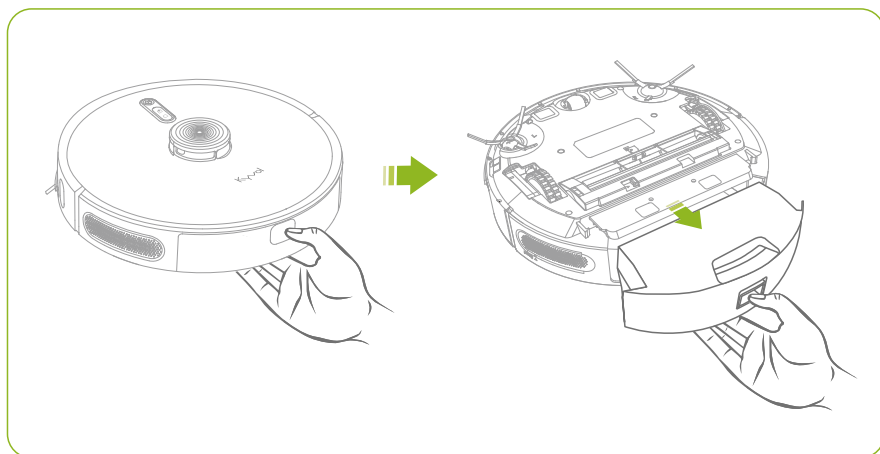

Step 2:

Open the upper cover of the **Dust Bin** and empty it into your home bin.

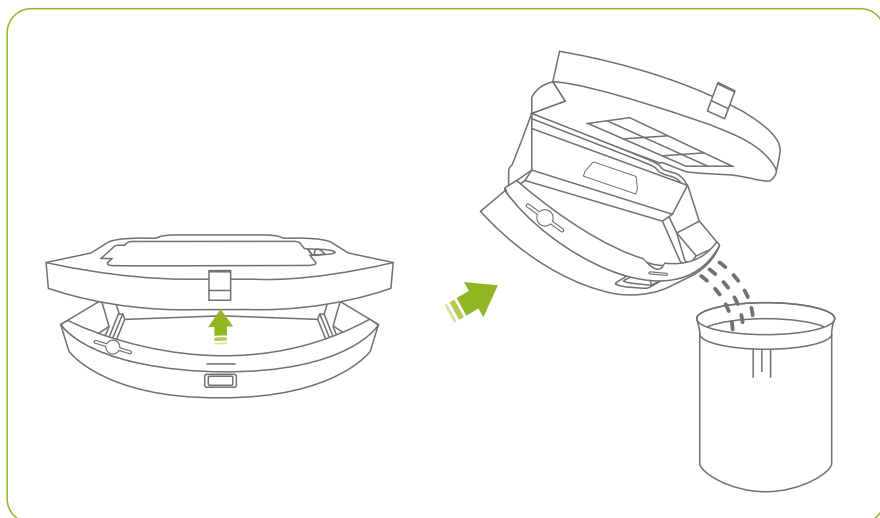

Step 3:

Close the **Dust Bin**, then open the **Filter Compartment**.

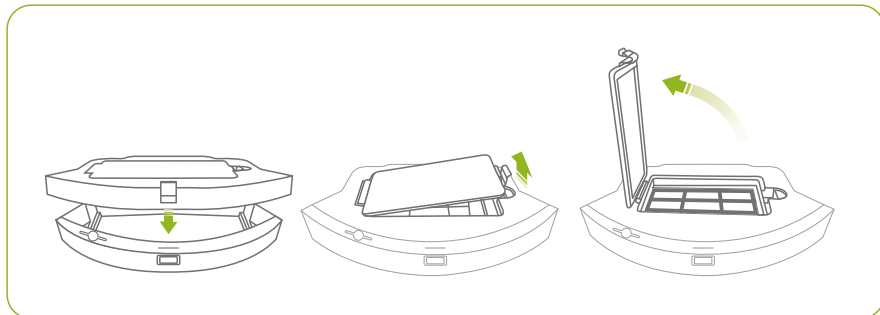
**Step 4:**

Take the **Filter** out, then tap the dust into your home bin.

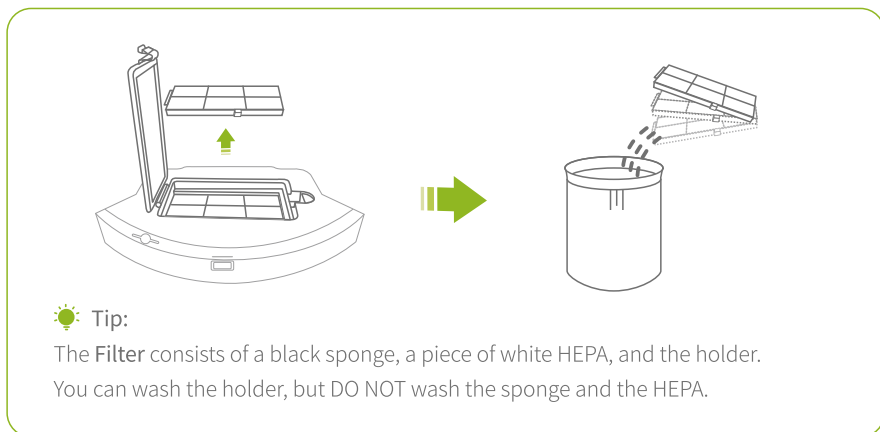

 **Tip:**

The **Filter** consists of a black sponge, a piece of white HEPA, and the holder. You can wash the holder, but **DO NOT** wash the sponge and the HEPA.

Step 5:

Place the **Filter** into the compartment, then insert the **Dust Bin** into the Cybovac.

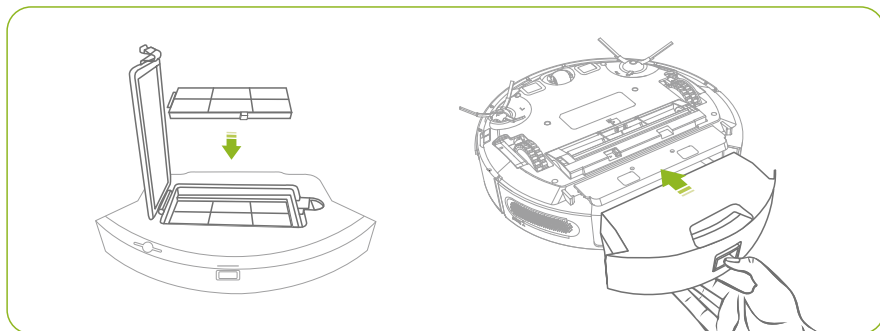

Tips:

- 1 The **Filter** effectively prevents dust and dirt from entering the inside of the Cybovac.
- 2 This protects its ventilation system and avoids secondary air pollution.
- 3 The **Cleaning Brush** (in the **Dust Bin**) can be used to clean the filter as well.

SIDE BRUSHES

Regularly cleaning or replacing the **Side Brushes** is recommended since they may become bent or damaged after a period of use.

Step 1:

Unscrew the **Side Brushes** with a screwdriver.

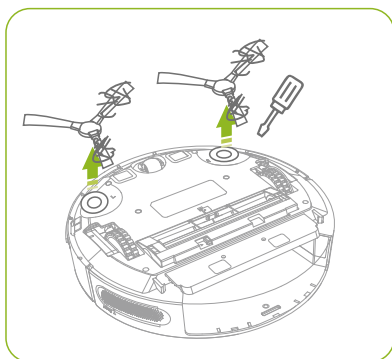

Step 2:

Take out the **Cleaning Brush** from the **Dust Bin** and utilize the blade of it to remove the hair or debris that is wrapping the brushes.

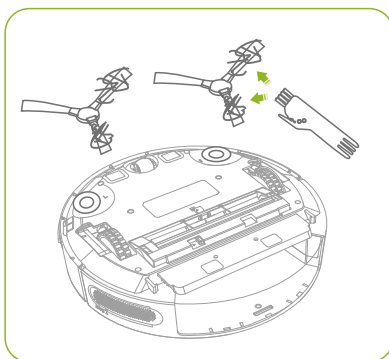

Step 3:

Clean the brushes with a damp cloth.

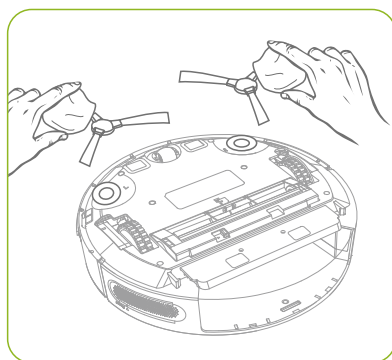

Step 4:

Screw the **Side Brushes** back into place. If the old brushes are damaged, you can directly install the new brushes.

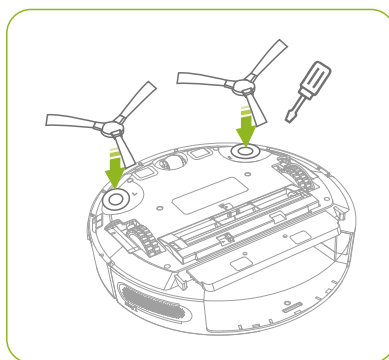

MAIN BRUSH

Step 1:

Turn over your Cybovac to find the Main Brush.

Step 2:

Press the latch on the left side to remove the **Brush Guard** over the brush.

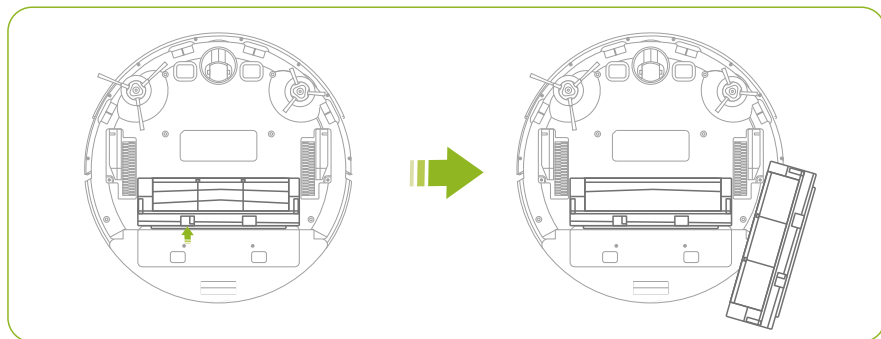

Step 3:

Take out the **Cleaning Brush** from the **Dust Bin**, then use the blade on it to cut the trapped hair and use the brush to remove the trapped dirt.

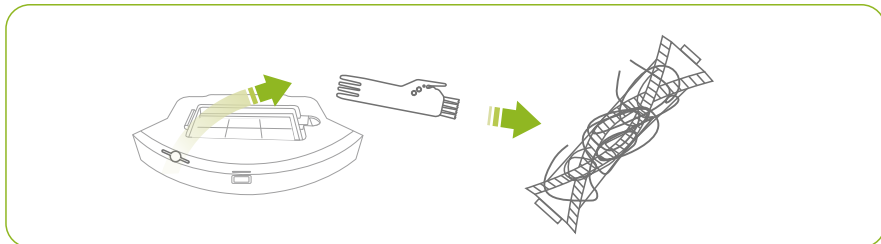

Step 4:

Insert the **Main Brush**, then install the **Brush Guard**.

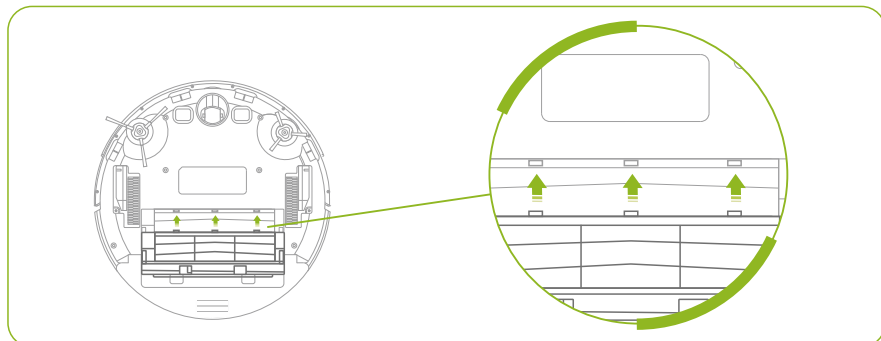

SENSORS AND CHARGING CONTACTS

1 Use a damp cloth to clean all sensors on the Cybovac and the base.

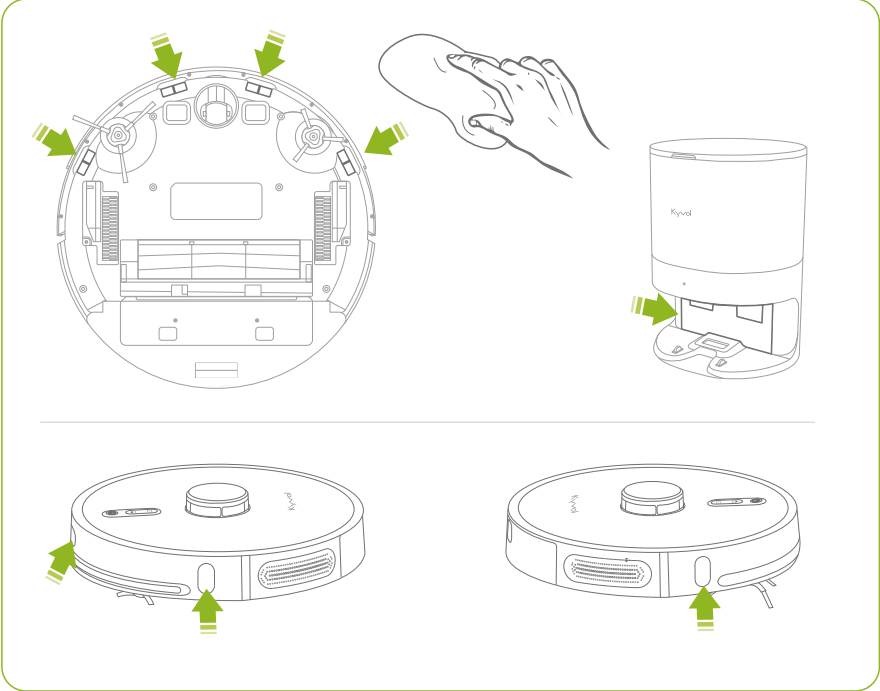

2 Use a dry cloth to clean the Charging Contacts on the Cybovac and the base (alcohol is not recommended).

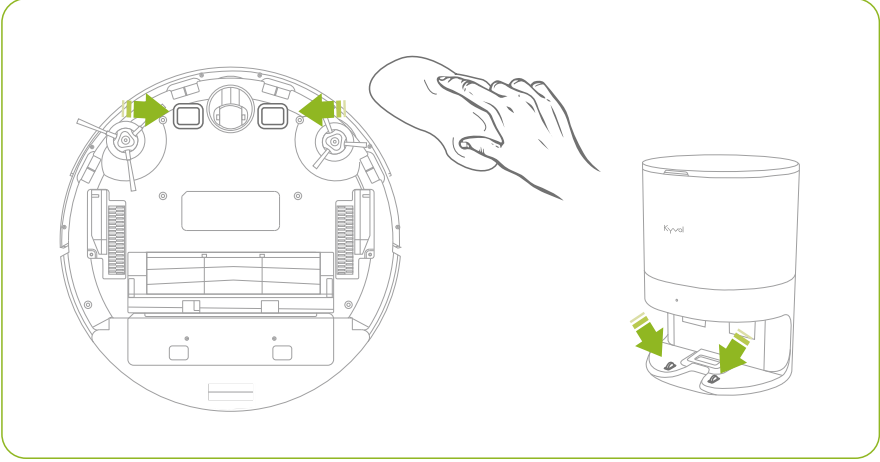

ROBOT TOP

Clean the top of the Cybovac with a damp cloth.

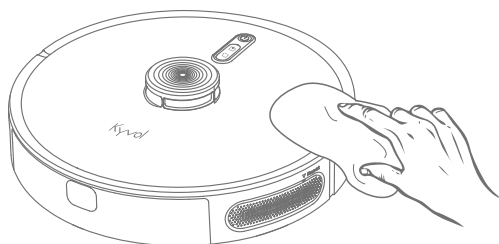

OMNI-DIRECTIONAL WHEEL

The Omni-directional Wheel cannot be removed from the Cybovac. Remove any trapped hair or debris from the wheel with the Cleaning Brush provided.

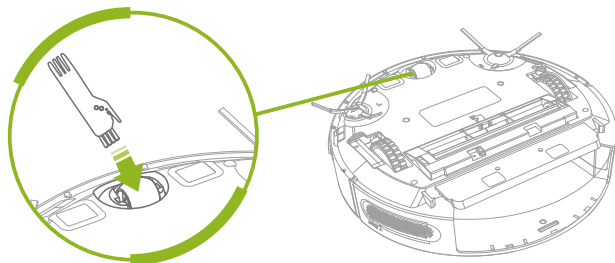

 Tip:

Do not clean the Omni-directional Wheel with water.

WATER TANK AND MOPPING PAD

Step 1:

Remove the Mopping Pad from the water tank and wash it.

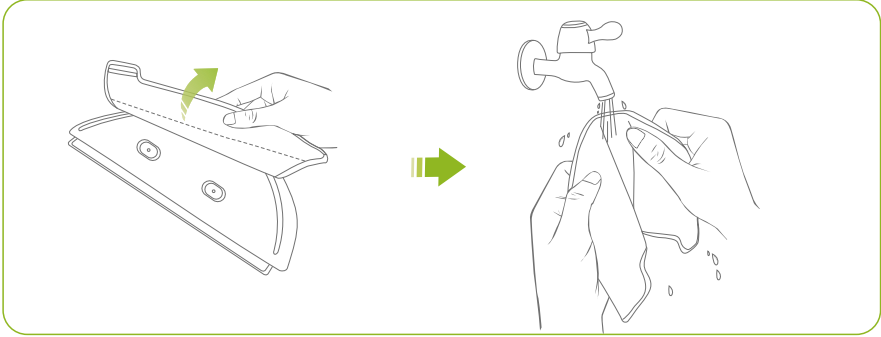

Step 2:

Empty out the Water Tank and rinse clean.

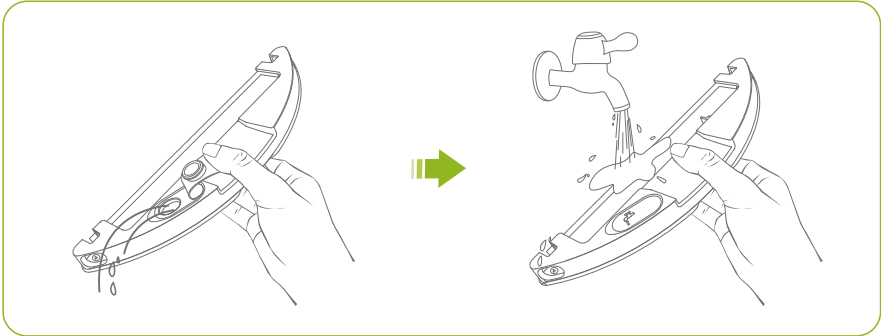

Step 3:

Air-dry the water tank and mopping pad.

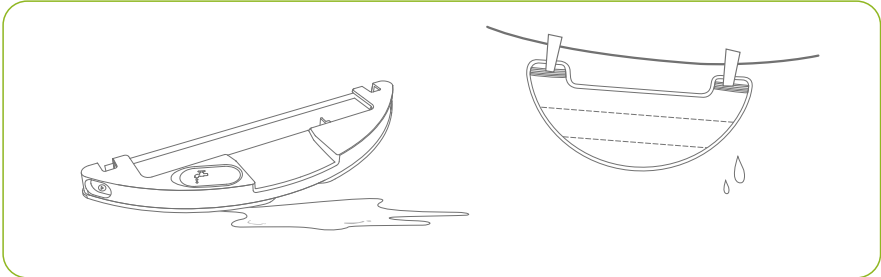

Step 4:

Reattach the mopping pad by sticking to the bottom of the Water Tank.

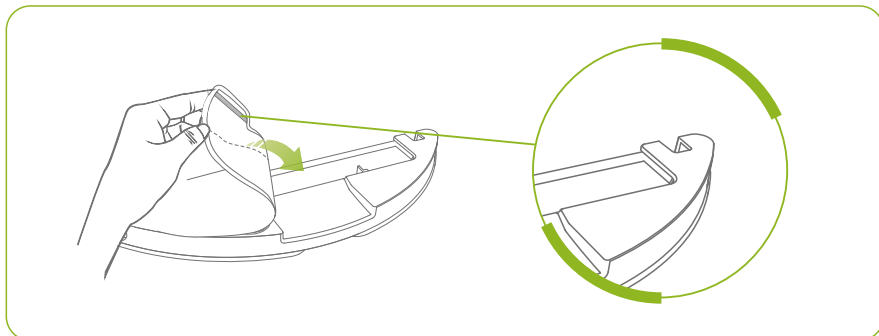
**! Notes:**

1. Do not use hot water or any cleaning solution to clean the water tank, which will cause damage to it.
2. Do not use hot water to clean the mopping pad.

IR LENS AND CHARGING/DUST COLLECTING CONTACTS

Check if the IR Lens and the Charging/Dust Collecting Contacts are contaminated. If yes, remove them with a clean and dry cloth.

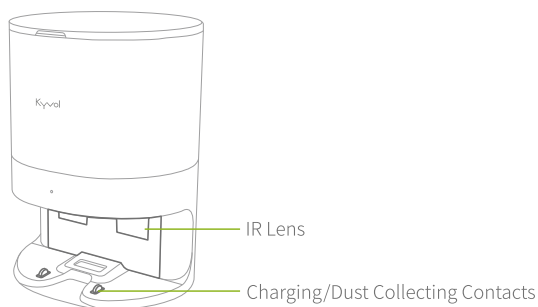

FAN FILTER SUPPORT

Check if the Fan Filter Support is contaminated by any debris. If so, remove them with a clean and dry cloth.

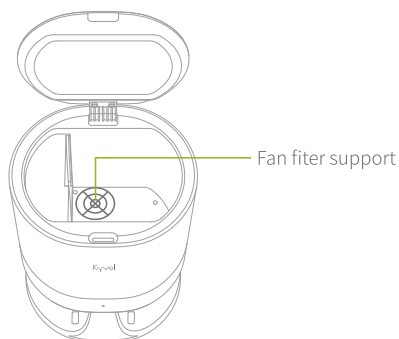

SPECIFICATIONS

Robot	Dimensions	350×350×98mm / (13.8×13.8×3.9in)
	Suction Power Levels	4 Levels
	Running Time (fully charged)	Average 240 minutes
	Cleaning Modes	Auto, Spot, Area, Edge
Dust Emptying Base	Dimensions	255×225×348.3mm / (10×8.9×13.7in)
	Dust Bag Capacity	4300ml
	Rated Working Voltage	AC 100-120V (US) / 220-240V (EU)
	Rated Power	1050W

TROUBLESHOOTING GUIDE

If there is any abnormal condition, the power indicator on the robot and the **Charge/Dust Collecting Indicator** on the base will be fast flashing orange, please check according to this **TROUBLESHOOTING GUIDE**. If you need any further assistance, please feel free to contact us at support@kyvol.com.

Q1. The Cybovac can not return to the Automatic Dust Emptying Base.

- *Make sure you have plugged in the **Automatic Dust Emptying Base**.
- *Check if there are too many obstacles near the **Automatic Dust Emptying Base**. Please put the base in an open area.
- *Check how far apart the Cybovac and base are. The further apart, the longer it will take to reach the base.
- *Check if the Cybovac battery level is critically low or empty.
- *It is recommended to control the robot back to the dust emptying base before the cleaning to let the robot memorize the starting point.

Q2. The Cybovac is not responding.

- *Make sure you have powered on the robot.
- *Check if the Cybovac battery level is critically low or empty.
- *Make sure that the batteries in the remote have power when operating the Cybovac with the remote.
- *When operating the Cybovac with the remote, check if the distance between the Cybovac and remote is within the effective range (3m/9.84ft).
- *Check if the ambient temperature is too low (lower than 0°C) or too high (higher than 50°C).

Q3. The remote doesn't work.

- *Make sure that the batteries in the remote have power.
- *Make sure you have powered on the robot.
- *Check if the Cybovac battery level is critically low or empty.
- *Check if the distance between the Cybovac and remote is within the effective range (3m/9.84ft).

Q4. My Cybovac has suddenly stopped working.



- *Check if the Cybovac is trapped or stuck.
- *Check if the Cybovac battery level is critically low or empty.
- *Make sure that you did not pause the Cybovac.

Q5. The Cybovac cannot start the scheduled cleaning.

- *Make sure you have powered on the robot.
- *Check if the scheduled time is set correctly (AM/PM).
- *Check if the Cybovac battery level is critically low or empty.
- *Check if you've cancelled the schedule.

*If the status of the robot is abnormal, it can't start the scheduled cleaning.

Q6. The suction power is weak or garbage leaking out of the robot.

*There are 4 levels of the suction power. Press   to adjust the level, and press  to adjust to the maximum suction power.

*Check if the **Dust Bin** is full or broken; If yes, empty the **Dust Bin** or replace with a new one.

*Check if the **Filter** components have been blocked; if yes, clean the filter and replace the HEPA when necessary.

*Check if the **Main Brush** is wrapped by foreign objects; if yes, please clean the **Main Brush**.

Q7. The Cybovac is making noises.

*The robot will produce some noises when cleaning, which is normal.

*If there is any sharp noises, please check if the **Main Brush** or the **Side Brushes** are tangled with any objects.

*Check if the robot collected any objects that can make noises inside the **Dust Bin**.

*There will be voice prompts from the robot when anything abnormal happens. You can check what's happened to it.

Q8. The Cybovac won't charge.

*Check if the base has been plugged in.

*Make sure the **Charging Contacts** on the Cybovac are aligned with those on the base.

*Make sure there is enough space around the base, and there is no dust or obstruction on the surface of the **Charging/Dust Collecting Contacts**.

Q9. The Breakpoint Resume Cleaning doesn't work.

*Please go to Kyvol App to confirm that the robot is not in the **DO NOT DISTURB** mode. The robot will not clean in this mode.



Q10. The Cybovac cannot connect to WiFi.

*Make sure you've entered the right password.

*Keep the robot, mobile device and your router being as close as possible.

*Make sure you selected a 2.4GHz WiFi.

*It's not recommended to use public network.

*Long press  and  simultaneously for 3-5 seconds to reset the robot WiFi, then try again.

*Reinstall the Kyvol App and try to connect to WiFi again.

Q11. The Cybovac is always offline.

*Make sure you have powered on the robot.

*Check the network connection of your home WiFi.

Operation Frequency	IEEE 802.11b/g: 2412 ~ 2472 MHz IEEE 802.11n HT20: 2412 ~ 2472 MHz IEEE 802.11n HT40: 2422 ~ 2462 MHz
Transmit Power (EIRP)	≤ 20dBm(for CE)

FCC Caution

Any Changes or modifications not expressly approved by the party responsible for compliance could void the user's authority to operate the equipment.

This device complies with part 15 of the FCC Rules. Operation is subject to the following two conditions:

- (1) This device may not cause harmful interference, and
- (2) this device must accept any interference received, including interference that may cause undesired operation.

! Note:

This equipment has been tested and found to comply with the limits for a Class B digital device, pursuant to part 15 of the FCC Rules. These limits are designed to provide reasonable protection against harmful interference in a residential installation. This equipment generates, uses and can radiate radio frequency energy and, if not installed and used in accordance with the instructions, may cause harmful interference to radio communications. However, there is no guarantee that interference will not occur in a particular installation. If this equipment does cause harmful interference to radio or television reception, which can be determined by turning the equipment off and on, the user is encouraged to try to correct the interference by one or more of the following measures:

- Reorient or relocate the receiving antenna.
- Increase the separation between the equipment and receiver.
- Connect the equipment into an outlet on a circuit different from that to which the receiver is connected.
- Consult the dealer or an experienced radio/TV technician for help.

This equipment complies with FCC radiation exposure limits set forth for an uncontrolled environment. This equipment should be installed and operated with minimum distance 20cm between the radiator & your body.

This transmitter must not be co-located or operating in conjunction with any other antenna or transmitter.

ISED Warning

This device complies with Industry Canada licence-exempt RSS standard(s). Operation is subject to the following two conditions:

- (1) this device may not cause interference, and
- (2) this device must accept any interference, including interference that may cause undesired operation of the device.

Le présent appareil est conforme aux CNR d'Industrie Canada applicables aux appareils radio exempts de licence. L'exploitation est autorisée aux deux conditions suivantes :

- (1) l'appareil ne doit pas produire de brouillage, et
- (2) l'utilisateur de l'appareil doit accepter tout brouillage radioélectrique subi, même si le brouillage est susceptible d'en compromettre le fonctionnement.

The device is compliance with RF exposure guidelines, users can obtain Canadian information on RF exposure and compliance. The minimum distance from body to use the device is 20cm.

Le présent appareil est conforme Après examen de ce matériel aux conformité ou aux limites d'intensité de champ RF, les utilisateurs peuvent sur l' exposition aux radiofréquences et la conformité and compliance d'acquérir les informations correspondantes.

La distance minimale du corps à utiliser le dispositif est de 20cm.

CAUTION

RISK OF EXPLOSION IF BATTERY IS REPLACED BY AN INCORRECT TYPE
DISPOSE OF USED BATTERIES ACCORDING TO THE INSTRUCTIONS



The symbol indicates AC voltage



RECYCLING

This product bears the selective sorting symbol for Waste electrical and electronic equipment (WEEE). This means that this product must be handled pursuant to European directive 2012/19/EU in order to be recycled or dismantled to minimize its impact on the environment. User has the choice to give his product to a competent recycling organization or to the retailer when he buys a new electrical or electronic equipment.

This product can be used across EU member states.

EU Compliance Statement: Shenzhen VanTop Technology & Innovation Co., Ltd. hereby declares that this device is in compliance with the essential requirements and other relevant provisions of the Directive 2014/53/EU.

A copy of the EU Declaration of Conformity is available online at <https://doc.vantop.com/>.



CUSTOMER SUPPORT

North America : support@kyvol.com

United Kingdom : support.uk@kyvol.com



[@kyvolglobal](https://www.facebook.com/kyvolglobal)



www.kyvol.com



[@kyvol_global](https://www.instagram.com/kyvol_global)