

GO:MIXER

Owner's Manual



Connecting Devices	2
Adjusting the Volume	5
Record	6
Using a Backing Track for Karaoke (CENTER CANCEL)	7

Before using this unit, carefully read the leaflet "USING THE UNIT SAFELY" and "IMPORTANT NOTES." After reading, keep the document(s) where it will be available for immediate reference.

Connecting Devices

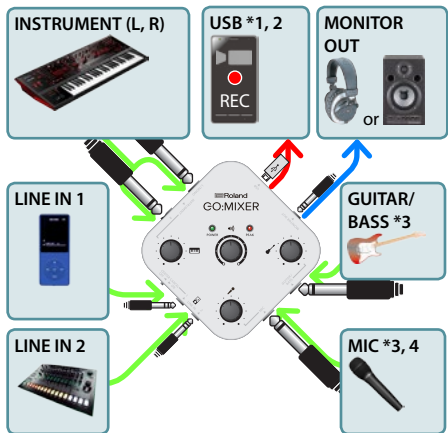

- 1.** To the GO:MIXER, connect the instrument, mic, or audio player etc. that you want to record.
- 2.** Connect the included USB cable first to the GO:MIXER and then to your

smartphone.

MEMO

If you are unable to record on your smartphone, slowly repeat step 2 once again.

- * 1: Connect only the included cable to this unit's USB port. Also, do not connect the included cable to any device other than this unit.
- * 2: If connecting an Android smartphone to this unit, connect the tagged plug to this unit.



- * 3: You must connect your guitar, bass, or mic to this jack.
If a mic and/or guitar are not connected, turn the [GUITAR/BASS] knob and/or [MIC] knob all the way to the left (the minimum setting). If the knob is not at the minimum setting, noise might enter the signal.
- * 4: If you're using an electret condenser mic that requires an external power supply, use this unit with a power supply box that's appropriate for your condenser mic.
- * To prevent malfunction and equipment failure, always turn down the volume, and turn off all the units before making any connections.

* In some cases, noise might be heard when you connect a smartphone, or when you start up or operate an app.

Adjusting the Volume

Adjust the knob so that the PEAK indicator lights briefly when your performance is loudest.

INSTRUMENT
(L, R)



MASTER
OUT *5



PEAK 
PEAK

If this stays lit, the sound is too loud.

MEMO



To adjust the volume of the devices connected to LINE IN 1 and LINE IN 2, use the volume controls of those devices.



GUITAR/
BASS



MIC



* 5: The [MASTER OUT] knob adjusts the overall volume that is recorded.

Record

When you're ready, use an app (such as a video camera) on your smartphone to record.



Using a Backing Track for Karaoke (CENTER CANCEL)

The sound from the device connected to LINE IN 1 can be used for karaoke (*6).

Set [CENTER CANCEL] to the "ON" position.

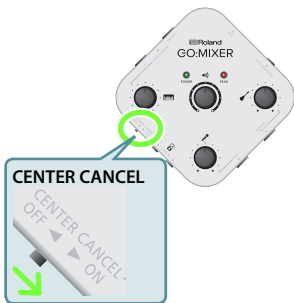

* 6: Depending on the sound, the instruments or vocals in the center might not be canceled completely.

* This document explains the specifications of the product at the time that the document was issued. For the latest information, refer to the Roland website.

<https://www.roland.com/>